

Pro 8300S/8310S/8320S

Pro 8310/8320



Operating Instructions

Replacement Guide: TCRU/ORU

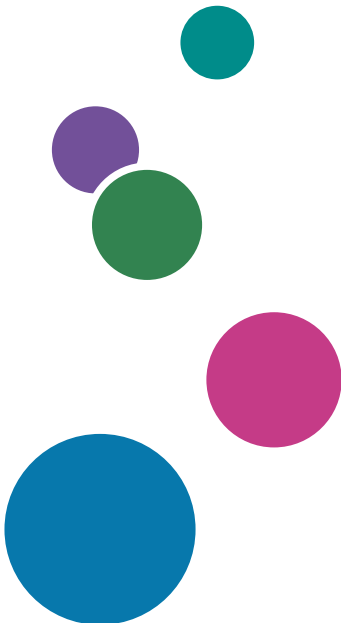

For safe and correct use, be sure to read Safety Information before using the machine.

TABLE OF CONTENTS

Introduction.....	3
How to Read This Manual.....	4
Symbols.....	4
Disclaimer.....	4
Symbols for Power Switch.....	4
Safety During Operation.....	5
Safety Precautions to Be Followed.....	6
Environments Where the Machine Can be Used.....	6
Handling power cords and power plugs.....	6
Handling the main machine.....	8
Handling the machine's interior.....	9
Handling the machine's supplies.....	10
1. Before You Begin	
What You Need.....	13
General Cautions.....	14
Names of Components.....	15
Control Panel.....	16
Turning Off/On the Power.....	17
Turning Off the Main Power.....	17
Turning On the Main Power.....	18
Specifying System Auto-Reset Timer.....	20
Preparation.....	21
Resetting the Replaceable Parts Counter.....	22
2. Replacing the Paper Feed Rollers	
Before You Begin.....	25
Tray Names.....	26
Position of the paper feed rollers.....	27
Replaceable Parts.....	28
Replacing the Rollers in Tray 1.....	30
If A3 Tray Unit Is Attached.....	35
Replacing the Rollers in Tray 2/3.....	41
Replacing the Rollers in the Wide LCT.....	46
Replacing the Rollers in the Wide LCT 4.....	46

Replacing the Rollers in the Wide LCT 5/6.....	50
Replacing the Rollers in the LCT.....	56
Replacing the Rollers in the LCT 4.....	56
Replacing the Rollers in the LCT 5.....	60
Replacing the Rollers in the LCT 6.....	64
Replacing the Rollers in the Bypass Tray.....	69
Replacing the Rollers in the ADF.....	73

3. Development Unit

Before You Begin.....	83
Replaceable Parts.....	83
Replacing the Charger Unit/Cleaning Unit for Photoconductor Unit/Photoconductor Unit.....	85

4. Cleaning Unit for Image Transfer Belt

Before You Begin.....	99
Replaceable Parts.....	99
Replacing the Cleaning Unit for Image Transfer Belt.....	100

5. Paper Transfer Unit

Before You Begin.....	111
Replaceable Parts.....	111
Replacing the Paper Transfer Unit.....	112

6. Fusing Unit

Before You Begin.....	117
Replaceable Parts.....	117
Replacing the Fusing Cleaning Unit/Fusing Unit.....	119

7. Developer

Before You Begin.....	125
Replaceable Parts.....	125
Replacing the Developer.....	126

8. Waste Toner Bottle

Before You Begin.....	133
Replaceable Parts.....	134
Replacing the Waste Toner Bottle.....	135

Introduction

This manual contains detailed instructions and notes on the operation and use of this machine. For your safety and benefit, read this manual carefully before using the machine. Keep this manual in a handy place for quick reference.

This manual is only for operators who have received proper training.

- Never perform any procedure in this manual if you have not received proper training.
- If you have received training and are not sure how to perform a procedure, call your service representative.
- Even if you have received training, never attempt any procedure that is not shown in this manual.
- The contents of this manual are subject to change without prior notice. In no event will the company be liable for direct, indirect, special, incidental, or consequential damages as a result of handling or operating this machine.

How to Read This Manual

Symbols

This manual uses the following symbols:

Important

Indicates points to pay attention to when using the machine, and explanations of likely causes of paper misfeeds, damage to originals, or loss of data. Be sure to read these explanations.

Note

Indicates supplementary explanations of the machine's functions, and instructions on resolving user errors.

Reference

This symbol is located at the end of sections. It indicates where you can find further relevant information.

[]

Indicates the names of keys on the machine's display or control panels.



Disclaimer

Contents of this manual are subject to change without prior notice.

In no event will the company be liable for direct, indirect, special, incidental, or consequential damages as a result of handling or operating the machine.

Symbols for Power Switch

Symbols for power switch that are used for this machine are as follows:

-  : POWER ON
-  : POWER OFF
-  : STANDBY

Safety During Operation

In this manual, the following important symbols are used:

WARNING

Indicates a potentially hazardous situation which, if instructions are not followed, could result in death or serious injury.

CAUTION

Indicates a potentially hazardous situation which, if instructions are not followed, may result in minor or moderate injury or damage to property.

Safety Precautions to Be Followed

Environments Where the Machine Can be Used

WARNING

- Do not use flammable sprays or solvents in the vicinity of this machine. Also, avoid placing these items in the vicinity of this machine. Doing so could result in fire or electric shock.
- Do not place vases, plant pots, cups, toiletries, medicines, small metal objects, or containers holding water or any other liquids, on or close to this machine. Fire or electric shock could result from spillage or if such objects or substances fall inside this machine.

CAUTION

- Keep the machine away from humidity and dust. Otherwise a fire or an electric shock might occur.
- Do not place the machine on an unstable or tilted surface. If it topples over, an injury might occur.
- Do not obstruct the machine's vents. Doing so risks fire caused by overheated internal components.
- Do not place heavy objects on the machine. Doing so can cause the machine to topple over, possibly resulting in injury.
- Make sure the room where you are using the machine is well ventilated and spacious. Good ventilation is especially important when the machine is used heavily.

Handling power cords and power plugs

WARNING

- Do not use any power sources other than those that match the specifications shown in this manual. Doing so could result in fire or electric shock.
- Do not use any frequencies other than those that match the specifications shown. Doing so could result in fire or electric shock.
- Do not use multi-socket adaptors. Doing so could result in fire or electric shock.

WARNING

- Do not use extension cords. Doing so could result in fire or electric shock.
- Do not use power cords that are damaged, broken, or modified. Also, do not use power cords that have been trapped under heavy objects, pulled hard, or bent severely. Doing so could result in fire or electric shock.
- It is dangerous to handle the power cord plug with wet hands. Doing so could result in electric shock.
- Touching the prongs of the power cable's plug with anything metallic constitutes a fire and electric shock hazard.
- The supplied power cord is for use with this machine only. Do not use it with other appliances. Doing so could result in fire or electric shock.
- If the power cord is damaged and its inner wires are exposed or broken, contact your service representative for a replacement. Use of damaged power cords could result in fire or electric shock.
- Be sure to disconnect the plug from the wall outlet at least once a year and check for the following:
 - There are burn marks on the plug.
 - The prongs on the plug are deformed.
- If any of the above conditions exist, do not use the plug and consult your dealer or service representative. Use of the plug could result in fire or electric shock.
- Be sure to disconnect the power cord from the wall outlet at least once a year and check for the following:
 - The power cord's inner wires are exposed, broken, etc.
 - The power cord's coating has a crack or dent.
 - When bending the power cord, the power turns off and on.
 - Part of the power cord becomes hot.
 - The power cord is damaged.
- If any of the above conditions exist, do not use the power cord and consult your dealer or service representative. Use of the power cord could result in fire or electric shock.

CAUTION

- When disconnecting the power cord from the wall outlet, always pull the plug, not the cord. Pulling the cord can damage the power cord. Use of damaged power cords could result in fire or electric shock.
- Be sure to push the plug of the power cord fully into the wall outlet. Partially inserted plugs create an unstable connection that can result in unsafe buildup of heat.
- Be sure to disconnect the plug from the wall outlet and clean the prongs and the area around the prongs at least once a year. Allowing dust to build up on the plug constitutes a fire hazard.
- If this machine is not going to be used for several days or longer at a time, disconnect its power cord from the wall outlet.
- When performing maintenance on the machine, always disconnect the power cord from the wall outlet.

Handling the main machine

WARNING

- The following explains the warning messages on the plastic bag used in this product's packaging.
 - Keep the polythene materials (bags, etc.) supplied with this machine away from babies and small children at all times. Suffocation can result if polythene materials are brought into contact with the mouth or nose.
- Be sure to locate the machine as close as possible to a wall outlet. This will allow easy disconnection of the power cord in the event of an emergency.
- If the machine emits smoke or odours, or if it behaves unusually, you must turn off its power immediately. After turning off the power, be sure to disconnect the power cord plug from the wall outlet. Then contact your service representative and report the problem. Do not use the machine. Doing so could result in fire or electric shock.
- If metal objects, or water or other fluids fall inside this machine, you must turn off its power immediately. After turning off the power, be sure to disconnect the power cord plug from the wall outlet. Then contact your service representative and report the problem. Do not use the machine. Doing so could result in fire or electric shock.

WARNING

- Do not touch this machine if a lightning strike occurs in the immediate vicinity. Doing so could result in electric shock.

CAUTION

- Unplug the power cord from the wall outlet before you move the machine. While moving the machine, take care that the power cord is not damaged under the machine. Failing to take these precautions could result in fire or electric shock.
- After you move the machine, use the caster fixture to fix it in place. Otherwise the machine might move or come down to cause an injury.
- Contact your service representative if you need to lift the machine (such as when relocating it to another floor). Do not attempt to lift the machine without the assistance of your service representative. The machine will be damaged if it topples or is dropped, resulting in malfunction and risk of injury to users. The machine's various handling areas are for service engineer use only. Do not touch these areas.
- Do not look into the lamp. It can damage your eyes.
- Do not hold the control panel while moving the machine. Doing so may damage the control panel, cause a malfunction, or result in injury.
- Keep your hands away from the hinges and exposure glass when lowering the ADF. Not doing so result in an injury if your hands or fingers are pinched.

Handling the machine's interior

WARNING

- Do not remove any covers or screws other than those explicitly mentioned in this manual. Inside this machine are high voltage components that are an electric shock hazard and laser components that could cause blindness. Contact your sales or service representative if any of the machine's internal components require maintenance, adjustment, or repair.
- Do not attempt to disassemble or modify this machine. Doing so risks burns and electric shock. Note again that exposure to the laser components inside this machine risks blindness.

CAUTION

- Some of this machine's internal components get very hot. For this reason, take care when removing misfed paper. Not doing so could result in burns.

CAUTION

- The inside of the machine could be very hot. Do not touch the parts with a label indicating the "hot surface". Otherwise, an injury might occur.
- When removing jammed paper, make sure not to trap or injure your fingers.
- When loading paper, take care not to trap or injure your fingers.
- Keep your hands clear of the booklet finisher tray when removing misfed paper, pulling out or pushing in the finisher's staple unit. You can trap and injure your fingers if you do not.
- During operation, rollers for transporting the paper and originals revolve. A safety device has been installed so that the machine can be operated safely. But take care not to touch the machine during operation. Otherwise, an injury might occur.
- If the machine's interior is not cleaned regularly, dust will accumulate. Fire and breakdown can result from heavy accumulation of dust inside this machine. Contact your sales or service representative for details about and charges for cleaning the machine's interior.

Handling the machine's supplies

WARNING

- Do not incinerate toner (new or used) or toner containers. Doing so risks burns. Toner will ignite on contact with naked flame.
- Do not store toner (new or used) or toner containers anywhere near naked flames. Doing so risks fire and burns. Toner will ignite on contact with naked flame.
- Do not use a vacuum cleaner to remove spilled toner (including used toner). Absorbed toner may cause a fire or explosion due to electrical contact flickering inside the vacuum cleaner. However, it is possible to use a vacuum cleaner that is explosion-proof and dust ignition-proof. If toner is spilled on the floor, remove the spilled toner slowly using a wet cloth, so that the toner is not scattered.
- The following explains the warning messages on the plastic bag used in this product's packaging.
 - Keep the polythene materials (bags, etc.) supplied with this machine away from babies and small children at all times. Suffocation can result if polythene materials are brought into contact with the mouth or nose.

CAUTION

- The fusing unit becomes hot. When removing the fusing unit, wait for 20 minutes or more after opening the cover and confirm that the fusing unit is not hotter than the room temperature. Otherwise, you will be burned.
- The fusing unit weighs approximately around 17.0 kg (37.5 lb).
- When moving the fusing unit, lift it slowly and be careful not to strain yourself. Careless handling or over-exertion when lifting can result in breakage of the unit or injury to yourself.
- Do not crush or squeeze toner containers. Doing so can cause toner spillage, possibly resulting in dirtying of skin, clothing, and floor, and accidental ingestion.
- Store toner (new or used), toner containers, and components that have been in contact with toner out of reach of children.
- If toner or used toner is inhaled, gargle with plenty of water and move into a fresh air environment. Consult a doctor if necessary.
- If toner or used toner gets into your eyes, flush immediately with large amounts of water. Consult a doctor if necessary.
- If toner or used toner is swallowed, dilute by drinking a large amount of water. Consult a doctor if necessary.
- When removing jammed paper or replacing toner, avoid getting toner (new or used) on your clothing. If toner comes into contact with your clothing, wash the stained area with cold water. Hot water will set the toner into the fabric and make removing the stain impossible.
- Avoid getting toner on your clothes or skin when replacing toner filter. If your skin comes into contact with toner, wash the affected area thoroughly with soap and water.
- If toner gets on your clothing, wash with cold water. Hot water will set the toner into the fabric and may make removing the stain impossible.
- When removing jammed paper or replacing toner, avoid getting toner (new or used) on your clothing. If toner comes into contact with your clothing, wash the stained area with cold water. Hot water will set the toner into the fabric and make removing the stain impossible.
- When removing jammed paper or replacing toner, avoid getting toner (new or used) on your skin. If toner comes into contact with your skin, wash the affected area thoroughly with soap and water.

CAUTION

- When replacing a toner or waste toner container or consumables with toner, make sure that the toner does not splatter. Put the waste consumables in a bag after they are removed. For consumables with a lid, make sure that the lid is shut.
- Do not attempt to print on stapled sheets, aluminum foil, carbon paper, or any kind of conductive paper. Doing so risks fire.

SAFETY AND ECOLOGICAL NOTES FOR DISPOSAL

1. Do not incinerate toner bottles or used toner. Toner dust may ignite suddenly when exposed to an open flame.
2. Dispose of used toner and organic photoconductors in accordance with local regulations. (These are non-toxic supplies.)
3. Dispose of replaced parts in accordance with local regulations.

Disposing of used toner

This section describes what to do with used toner.

Toner cannot be re-used.

Pack used toner containers in the container's box or a bag to prevent the toner from leaking out of the container when you dispose of it.

 **Region A** (mainly Europe and Asia)

If you want to discard your used toner container, please contact your local sales office. If you discard it by yourself, treat it as general plastic waste material.

 **Region B** (mainly North America)

Please see our local company website for information on the recycling of supply products, or you can recycle items according to the requirements of your local municipalities or private recyclers.

1. Before You Begin

What You Need

1

Use only the tools and materials described in this manual. Using other tools or materials could damage the machine or cause injury.

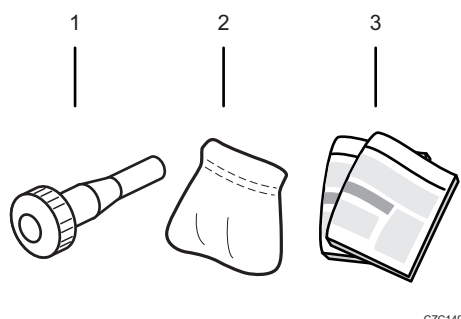

1. Hex screwdriver

Use this to remove black hexagonal-head screws from the machine.

2. Drum setting powder pad applicator

Needed to apply a thin coated of powder on the drum.

3. Newspaper or other paper

To prevent toner and other stains getting on the floor, spread sheets of paper out where you intend to place the removed parts.

↓ Note

- The hex screwdriver and drum setting powder pad applicator are included in the maintenance kit. Keep them somewhere safe. If the maintenance kit has any items missing, contact your service representative.

General Cautions

★ Important

- **Never remove any screw unless you are instructed to do so.**

Handles and levers

- Purple handles and levers are for pulling or lifting parts when you move or remove them. Purple labels on parts indicate exactly where to hold the parts when pulling or lifting them.

Screws

- Replaceable components are secured with black screws. Never remove screws that are not black.
- The hex screwdriver is used to clench the heads of screws, so that they do not drop into the machine during removal.

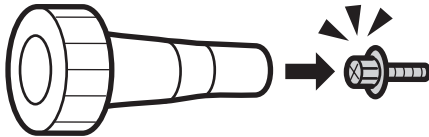

CWH161

Names of Components

⚠ WARNING

- Do not remove any covers or screws other than those explicitly mentioned in this manual. Inside this machine are high voltage components that are an electric shock hazard. Contact your sales or service representative if any of the machine's internal components require maintenance, adjustment, or repair.
- Do not attempt to disassemble or modify this machine. Doing so risks burns and electric shock.

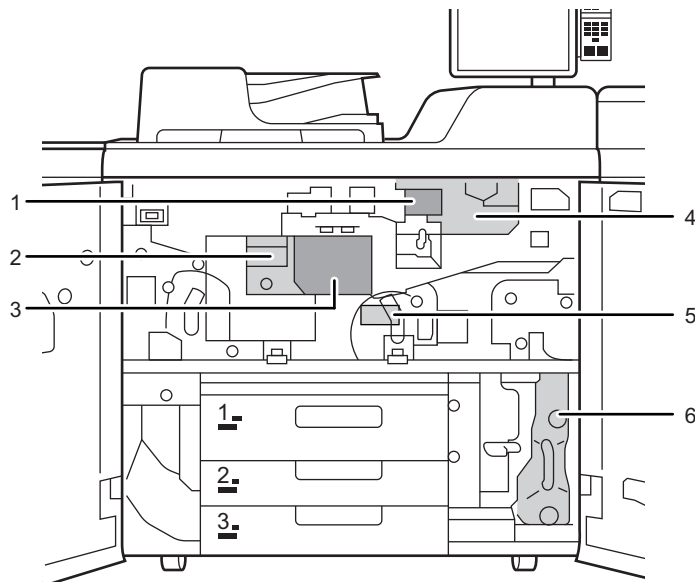

ECG003

1. Developer outlet/inlet
2. Fusing unit
3. Cleaning unit for image transfer belt
4. Development unit
5. Paper transfer unit
6. Waste toner bottle

Control Panel

1

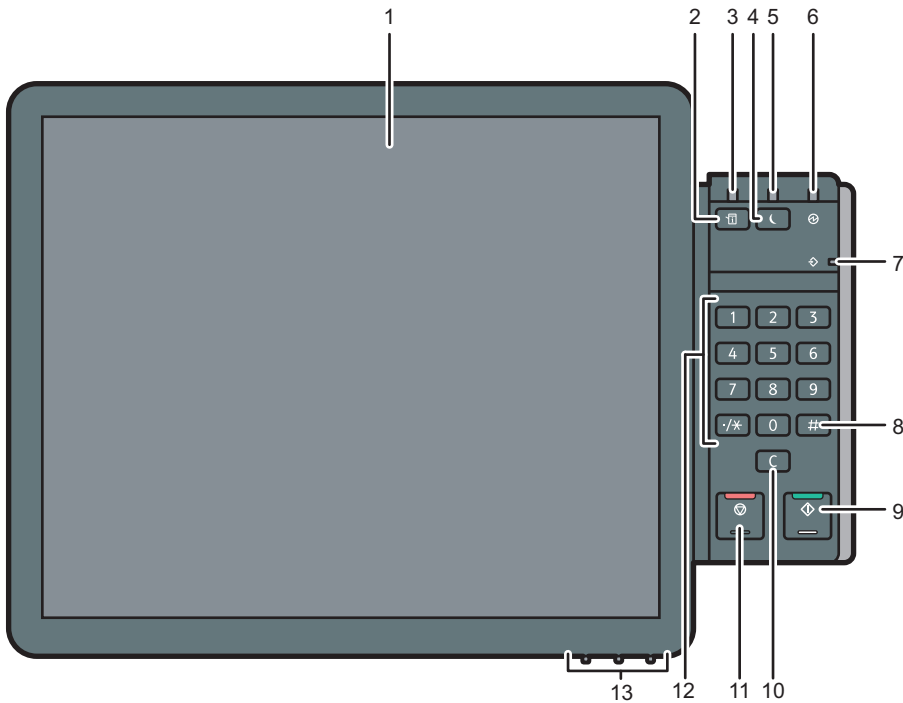

ECH003

1. Display panel
2. [Check Status] key
3. Status indicator
4. [Energy Saver] key
5. Energy saver indicator
6. Main power indicator
7. Data In indicator (printer mode)
8. [#] key (Enter key)
9. [Start] key
10. [Clear] key
11. [Stop] key
12. Number keys
13. Display adjustment keys

Turning Off/On the Power

★ Important

- Turn off the main power before carrying out any of the operations described in this manual.

The main power switch is on the left side of the machine. When this switch is turned on, the main power turns on and the main power indicator lights up. When this switch is turned off, the main power turns off and the main power indicator goes out.

Turning Off the Main Power

⚠ CAUTION

- When disconnecting the power cord from the wall outlet, always pull the plug, not the cord. Pulling the cord can damage the power cord. Use of damaged power cords could result in fire or electric shock.

★ Important

- Do not turn off the power while the machine is in operation.
- Do not hold down the main power switch while turning off the main power. Doing so forcibly turns off the machine's power and may damage the hard disk or memory and cause malfunctions.

1. Open the main power switch cover, and then push the main power switch.

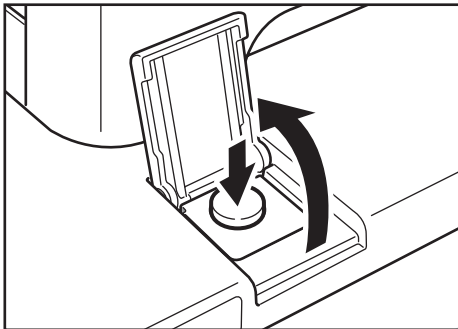

CZC150

The main power indicator goes out. The main power turns off automatically when the machine shuts down. If the screen on the control panel does not disappear, contact your service representative.

2. Open the front covers.

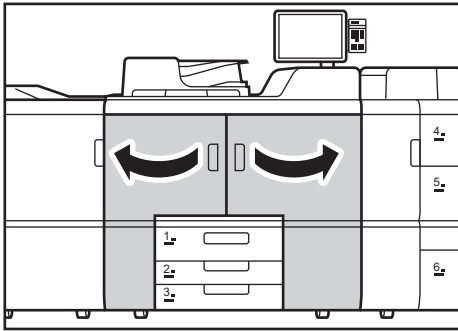

ECG006

3. Push the AC power switch.

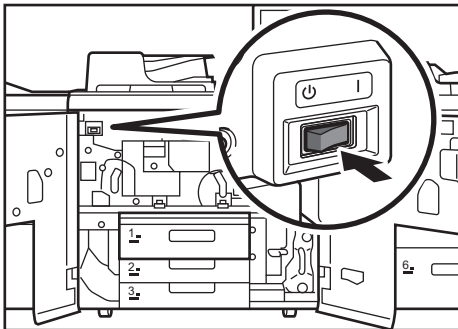

ECG072

4. Unplug the machine and its optional devices from the wall outlet.

Turning On the Main Power

1. Plug the machine and its optional devices into the wall outlet.

2. Open the front covers.

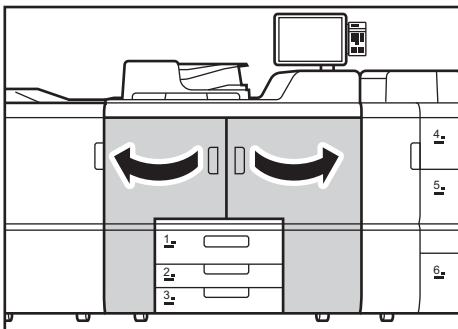

ECG006

3. Push the AC power switch.

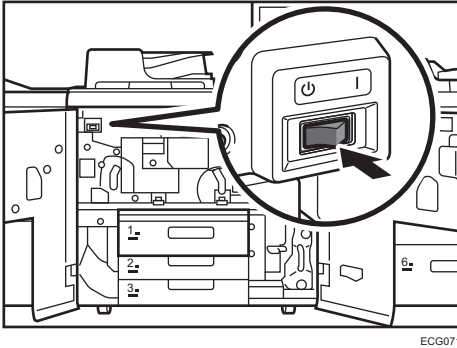

4. Open the main power switch cover, and push the main power switch.

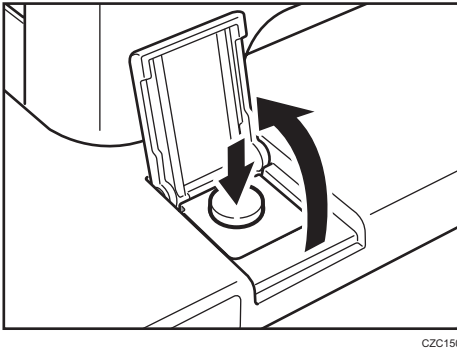

The main power indicator goes on.

Note

- After you switch the main power on, a screen may appear to indicate that the machine is initializing. Do not switch the power off during this process. Initialization takes about 16 minutes.
- If the machine does not turn on even if you press the main power switch, open the front covers and make sure that the AC power switch is turned on. For details about the AC power switch, see "Dos and Don'ts", Maintenance and Management.
- Application icons appear on the [Home] screen as the applications start running.

Specifying System Auto-Reset Timer

To prevent the machine from switching screens while you are replacing parts, set [System Auto Reset Timer] to "Off". After replacing the parts return the setting to "On", if necessary.

Note

- For details about changing this setting, see Device Management, which is supplied with this machine.

Preparation

Spread newspaper or other paper in front of the machine before removing any parts.

- The newspaper or other paper will catch small amounts of toner or shreds of dry lubricant that may fall out of the PCUs when they are removed.

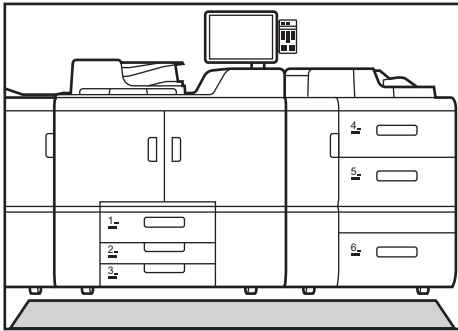

ECG005

Resetting the Replaceable Parts Counter

1

1. Open the front covers.

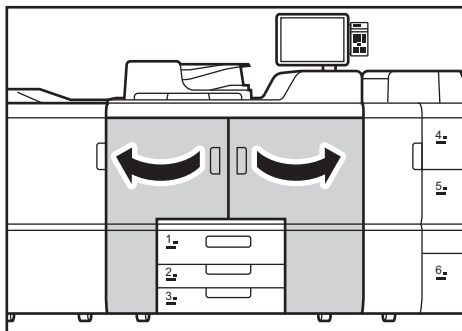

ECG006

2. Turn the machine on.

See page 17 "Turning Off/On the Power".

3. Access the Adjustment Settings for Operators menu.

See "Accessing Adjustment Settings for Operators", Adjustment Item Menu Guide: TCRU/ORU.

4. Press [Main Unit: Maintenance].

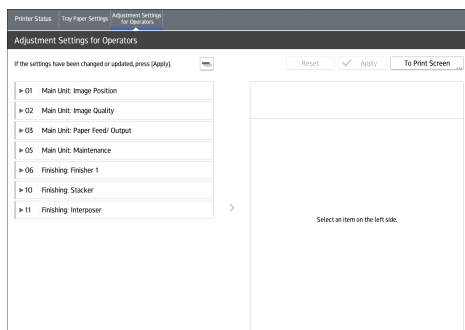

5. Press [Reset Parts Counter].

6. Press the button of the part that has been replaced.

7. Press [Execute].

8. Turn the machine off.

See page 17 "Turning Off/On the Power".

9. Close the front covers.

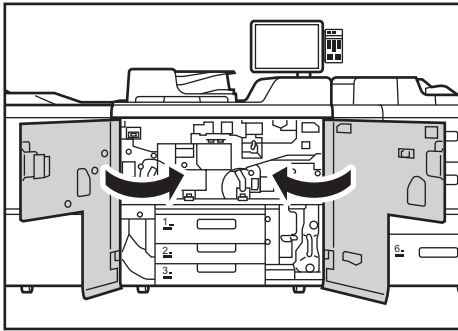

ECG007

10. Turn the machine on.

The counter for the replaced component is reset. The setting for adjusting the machine for the replaced component is executed automatically.

11. Access the Adjustment Settings for Operators menu.

See "Accessing Adjustment Settings for Operators", Adjustment Item Menu Guide: TCRU/ORU.

12. Press [Main Unit: Maintenance].

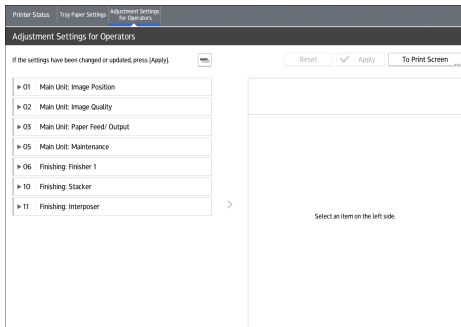

13. Press [Display Parts Life Counter].

14. Make sure the counter has been reset.

2. Replacing the Paper Feed Rollers

Before You Begin

★ Important

- The three rollers must be replaced together.
- Handle new rollers carefully and avoid touching their surfaces with bare hands.
- If you lose a snap ring, contact your service representative.

What You Need

- Hex screwdriver

Time for Replacement

A message will appear when it nears the time to replace a component.

Print the counter list.

1. Press [Counter] at the bottom of the screen in the right.
2. To print a counter list, press [Print Counter List], and then press the [Start] key.
3. Press [Exit].

Tray Names

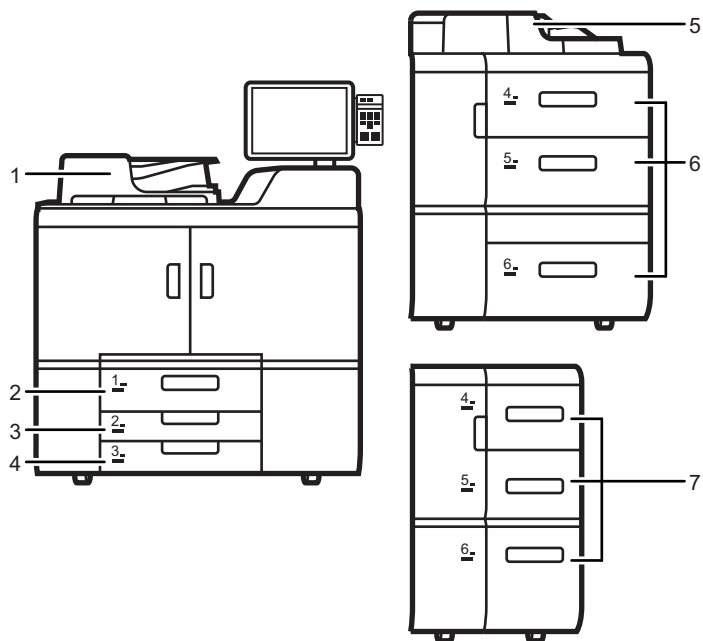

ECG008

1. ADF
2. Tray 1
3. Tray 2
4. Tray 3
5. Multi bypass tray (Tray A)
6. Tray 4-6 (wide LCT)
7. Tray 4-6 (LCT)

Position of the paper feed rollers

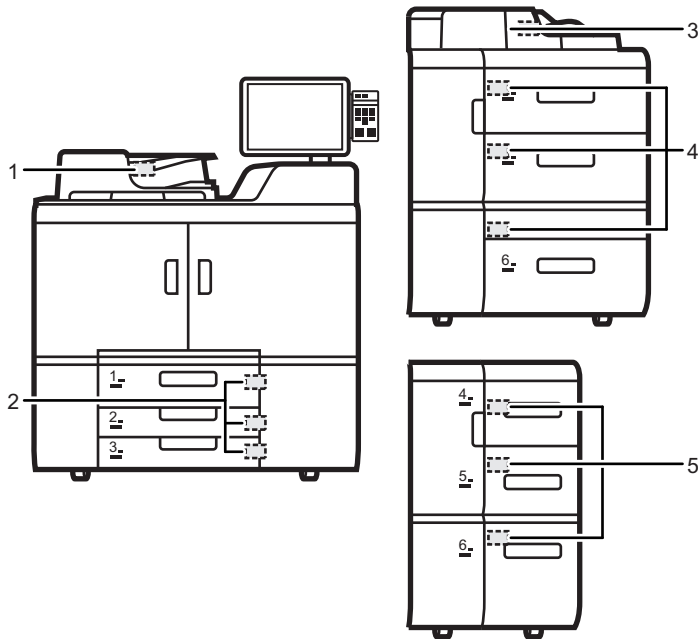

ECG009

1. ADF
2. Trays 1-3
3. Multi bypass tray (Tray A)
4. Tray 4-6 (wide LCT)
5. Tray 4-6 (LCT)

Replaceable Parts

Trays 1-3

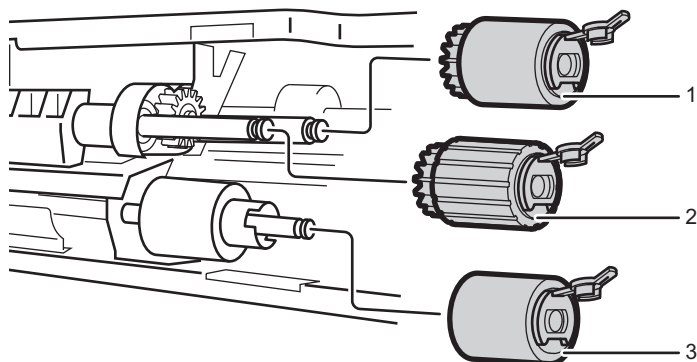

ECG010

1. Feed roller
2. Pick-up roller
3. Separation roller

Trays 4-6 (Wide LCD/LCD)

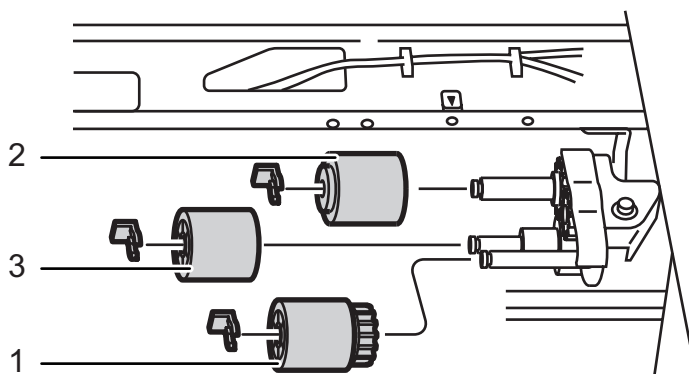

CZC143

1. Pick-up roller
2. Feed roller
3. Separation roller

Multi bypass tray

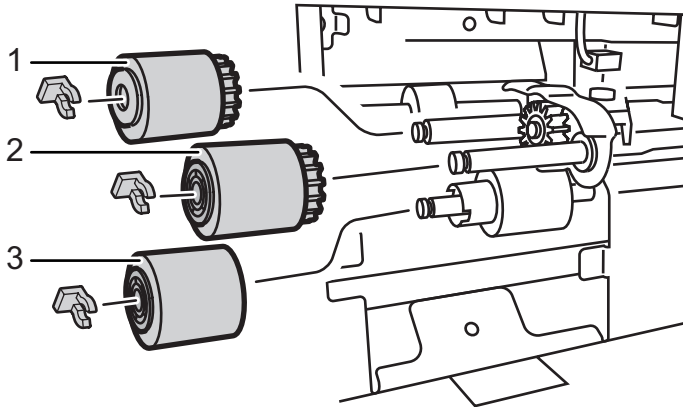

CZC144

1. Feed roller
2. Pick-up roller
3. Separation roller

ADF

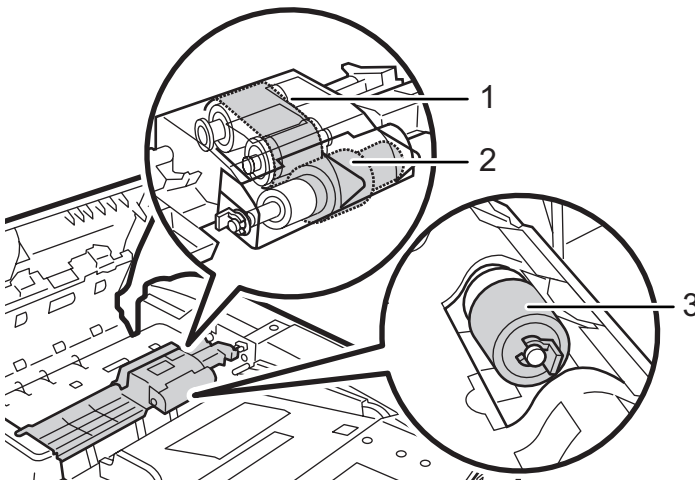

CZC155

1. Paper feed belt
2. Pick-up roller
3. Separation roller

Replacing the Rollers in Tray 1

1. Open the front covers.

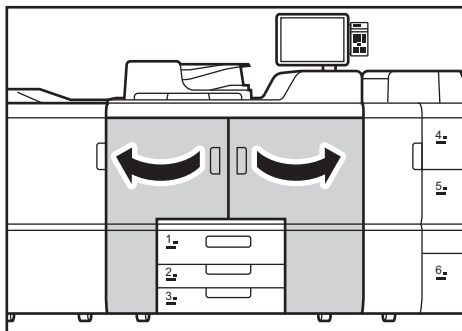

ECG006

2. Pull open the tray until it stops.

Remove any paper in the tray.

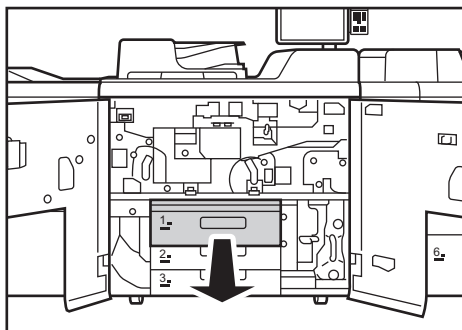

ECG011

3. Remove the 2 screws.

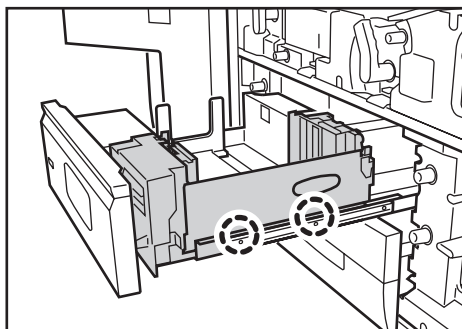

CZC003

4. Holding the handle on the right front of the tray, slip your hand into the opening in the right side to support it, and lift it up slightly.

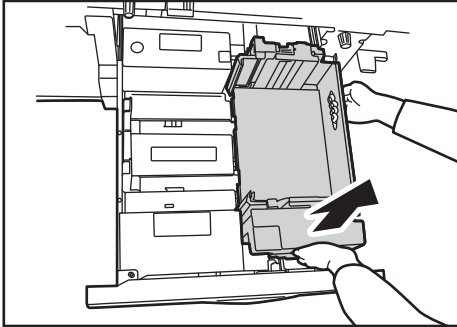

ECG030

5. Lifting the right side slightly, tilt the tray upward to unlock it, and then pull it out.

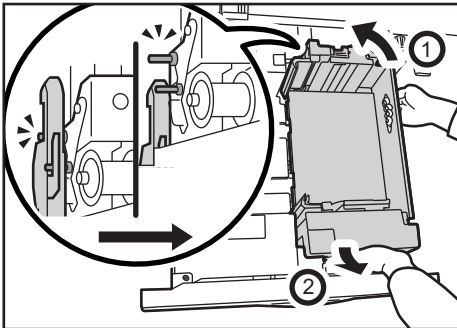

ECG031

The connectors on the rear of the tray have sharp edges. Be careful not to touch them.

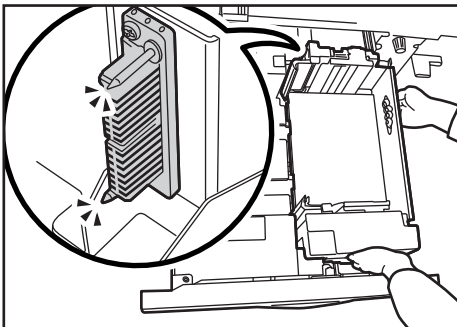

ECG032

6. Push the guide rail back into the machine.

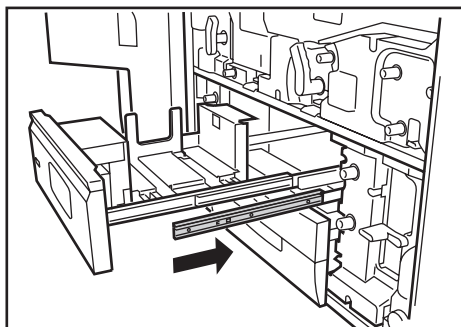

CZC004

7. Remove the paper feed roller in the following order:

- (1) Pick-up roller
- (2) Feed roller
- (3) Separation roller

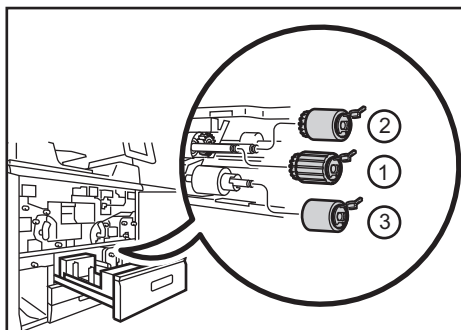

ECG013

Unlock and remove the paper feed roller.

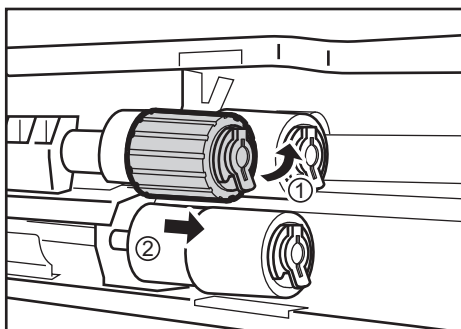

ECG015

If the optional anti-humidity heater is installed, there is an optional anti-humidity heater near the roller.

The optional anti-humidity heater may be hot, so to avoid burns, be careful not to touch it.

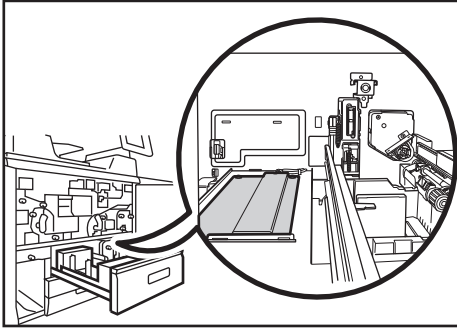

ECG033

8. Attach the new paper feed roller in the following order:

- (1) Separation roller
- (2) Feed roller
- (3) Pick-up roller

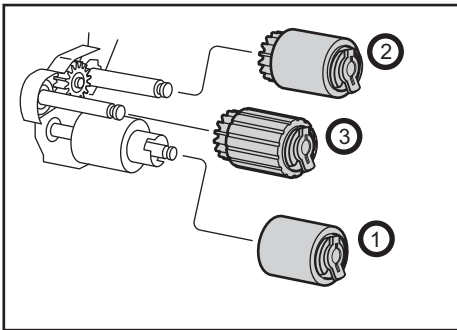

ECG014

Replace the paper feed rollers and lock them in place.

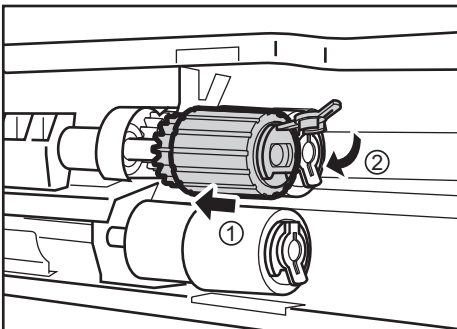

ECG016

9. Pull out the guide rails.

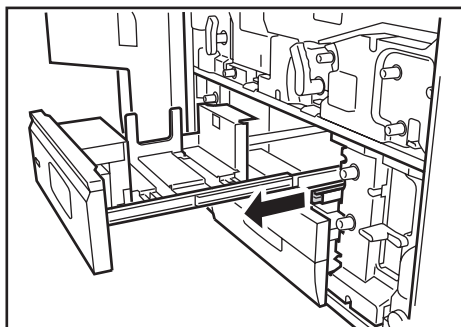

CZC009

10. Engage the tray with the guide rails' thread holes.

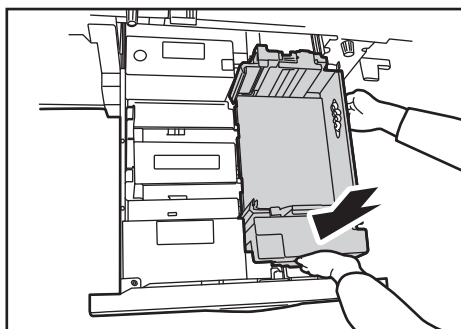

ECG054

11. Secure the tray with the 2 screws.

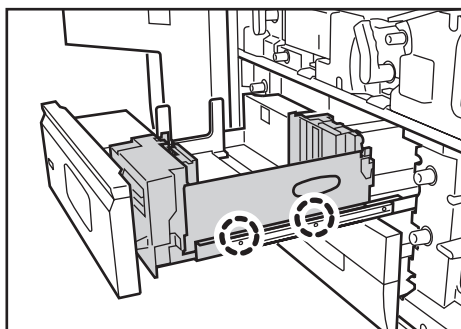

CZC003

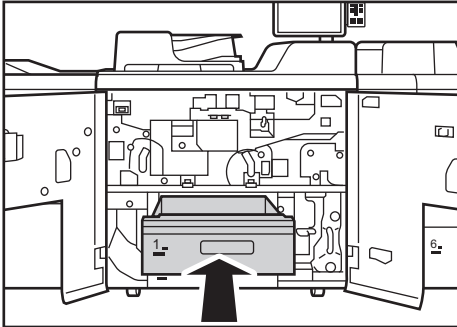
12. Push the tray back into the machine.

ECG012

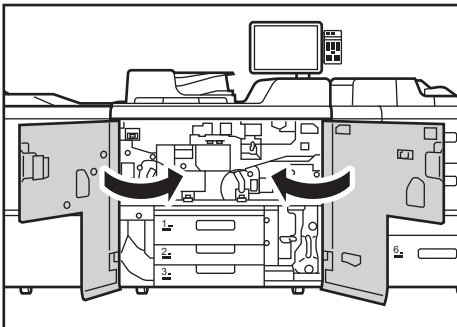
13. Close the front covers.

ECG007

14. Reset the counter for replaceable parts.

Do not turn the machine on until you have read how to do so.

See page 22 "Resetting the Replaceable Parts Counter".

If A3 Tray Unit Is Attached

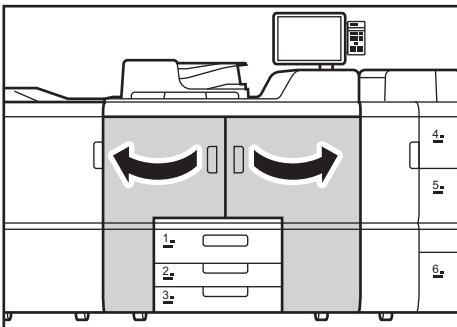
1. Open the front covers.

ECG006

2. Pull open the tray until it stops.

Remove any paper in the tray.

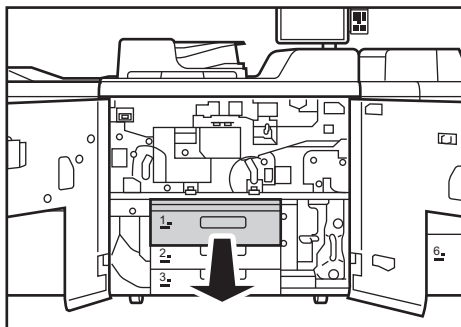

ECG011

3. Remove the 4 screws.

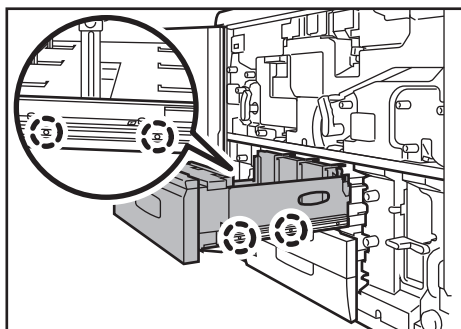

ECG036

4. Holding the handle on the left side of the tray, slip your hand into the opening on the right side to support it, and pull it out.

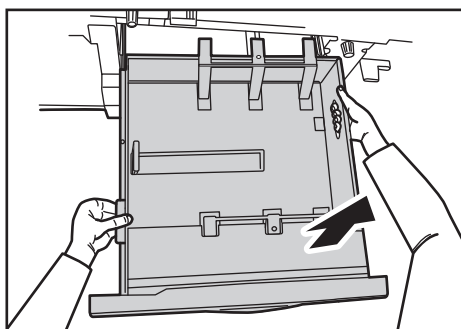

ECG035

The connectors on the back of the tray have sharp edges. Be careful not to touch them.

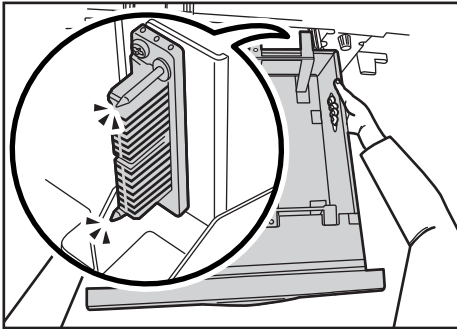

ECG037

5. Push the guide rails back into the machine.

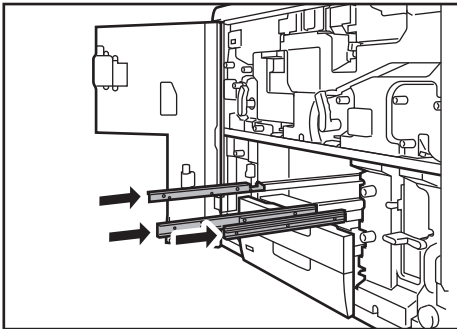

ECG075

6. Remove the paper feed roller in the following order:

- (1) Pick-up roller
- (2) Feed roller
- (3) Separation roller

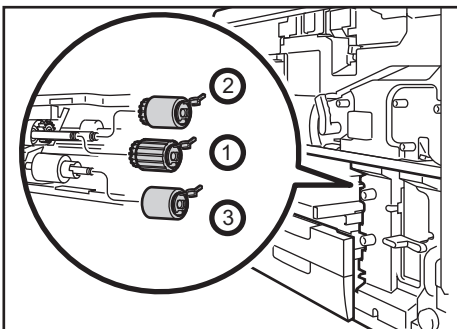

ECG017

Unlock and remove the paper feed roller.

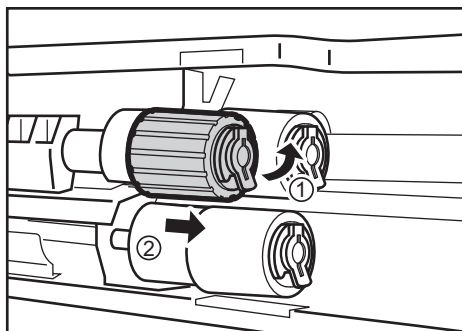

ECG015

If the optional anti-humidity heater is installed, there is an optional anti-humidity heater near the roller.

The optional anti-humidity heater may be hot, so to avoid burns, be careful not to touch it.

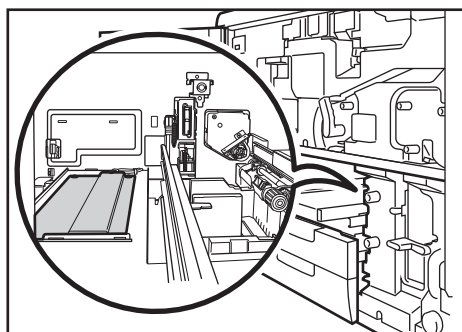

ECG034

7. Attach the new paper feed roller in the following order:

- (1) Separation roller
- (2) Feed roller
- (3) Pick-up roller

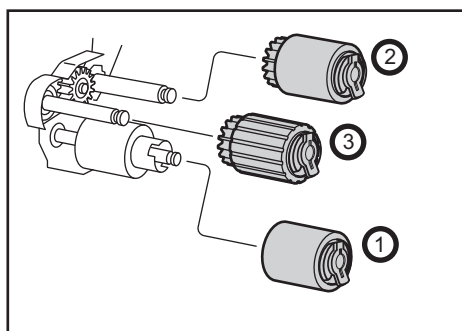

ECG014

Replace the paper feed rollers and lock them in place.

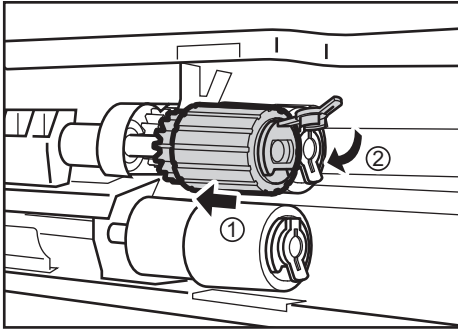

ECG016

8. Pull out the guide rails.

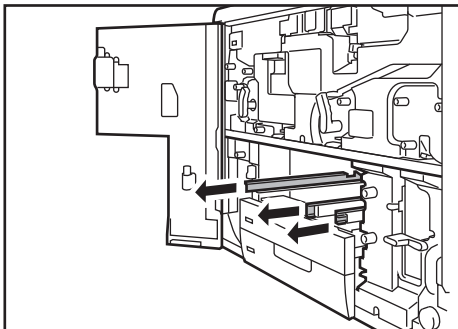

ECG076

9. Replace the inner tray, aligning it with the screw holes in the left and right guide rails.

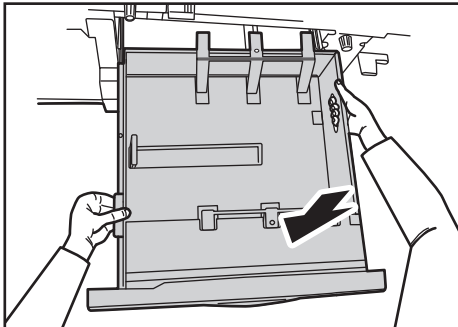

ECG055

When putting the tray on the guide rails, align the hole in the bottom of the tray with the pin on the center rail.

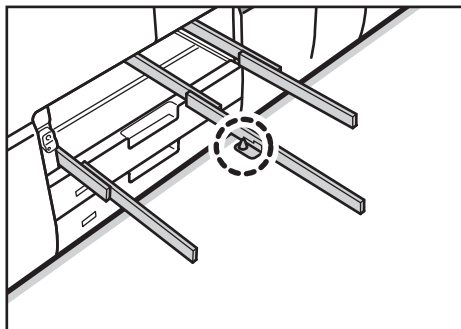

DTH014

10. Secure the tray with the 4 screws.

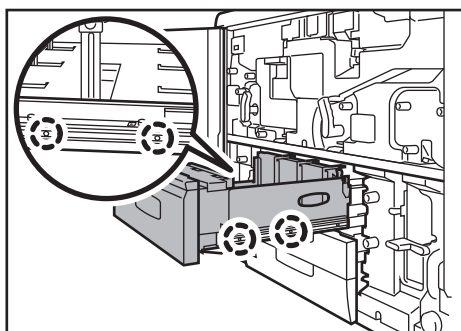

ECG036

11. Push the tray back into the machine.

12. Close the front covers.

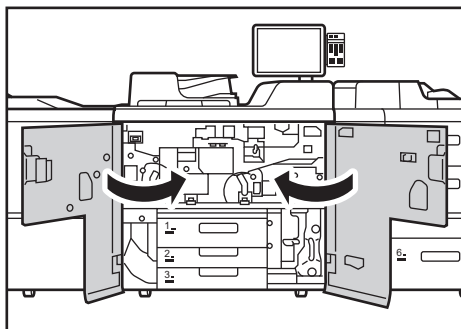

ECG007

13. Reset the counter for replaceable parts.

Do not turn the machine on until you have read how to do so.

See page 22 "Resetting the Replaceable Parts Counter".

Replacing the Rollers in Tray 2/3

1. Open the front covers.

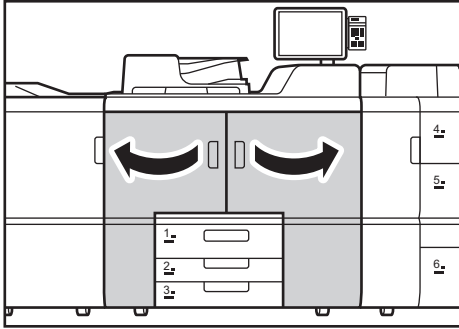

ECG006

2. Remove tray 1.

For details about how to remove tray 1, see steps 2 through 6 on page 30 "Replacing the Rollers in Tray 1".

If the optional A3 tray unit is attached, see steps 2 through 5 on page 35 "If A3 Tray Unit Is Attached".

3. Pull tray 3 out until it stops.

The figures in the following steps assume that tray 1 is pulled out.

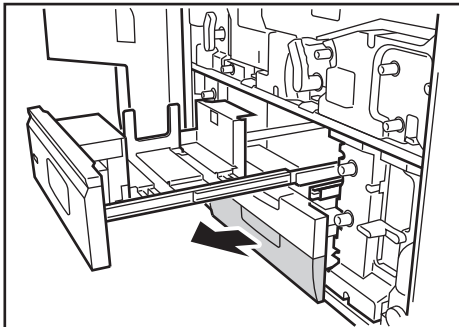

ECG057

4. Pull tray 2 out until it stops.

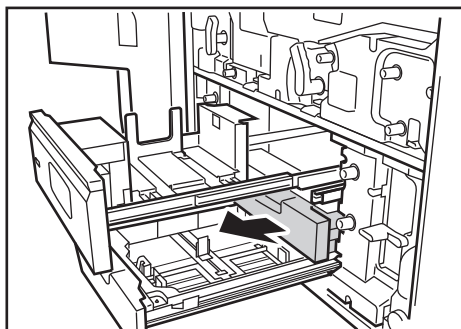

ECG056

5. Remove the paper feed roller in the following order:

- (1) Pick-up roller
- (2) Feed roller
- (3) Separation roller

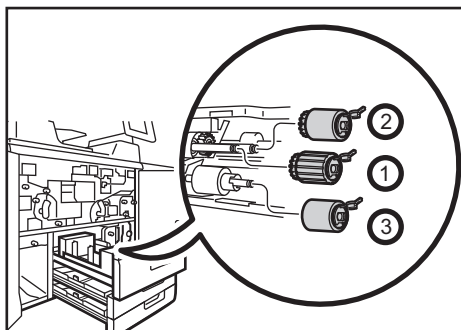

ECG018

Unlock and remove the paper feed roller.

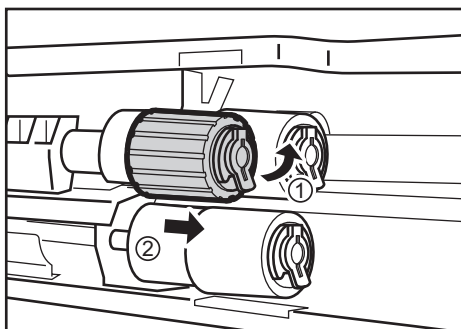

ECG015

If the optional anti-humidity heater is installed, there is an optional anti-humidity heater near the roller.

The optional anti-humidity heater may be hot, so to avoid burns, be careful not to touch it.

- Tray 1 position

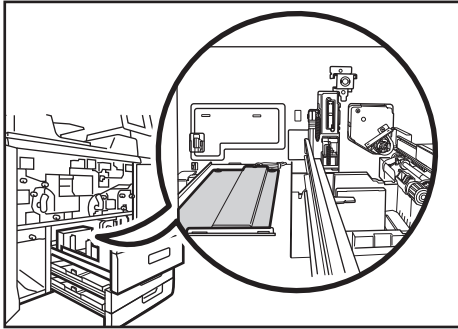

ECG044

- Tray 3 position

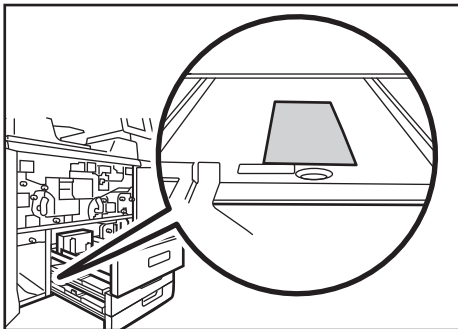

ECG045

6. Attach the new paper feed roller in the following order:

- (1) Separation roller
- (2) Feed roller
- (3) Pick-up roller

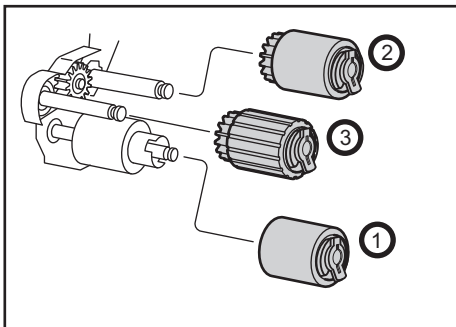

ECG014

Replace the paper feed rollers and lock them in place.

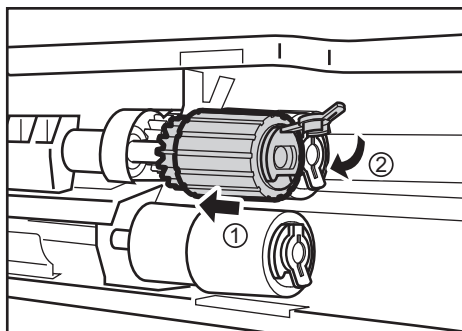

ECG016

7. Push tray 2 back into the machine.

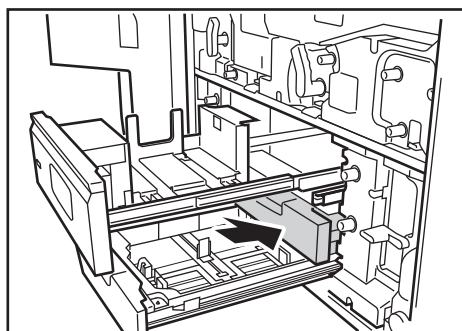

ECG058

8. Push tray 3 back into the machine.

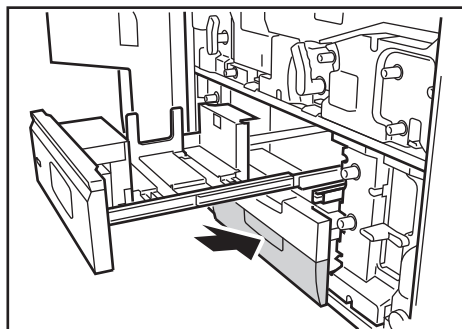

ECG059

9. Replace tray 1.

For details about how to replace tray 1, see steps 9 through 12 on page 30 "Replacing the Rollers in Tray 1".

If the optional A3 tray unit is attached, see steps 8 through 10 on page 35 "If A3 Tray Unit Is Attached".

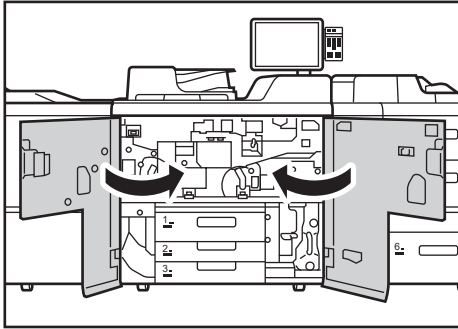
10. Close the front covers.

ECG007

11. Reset the counter for replaceable parts.

Do not turn the machine on until you have read how to do so.

See page 22 "Resetting the Replaceable Parts Counter".

Replacing the Rollers in the Wide LCT

Replacing the Rollers in the Wide LCT 4

2

1. Open the front cover.

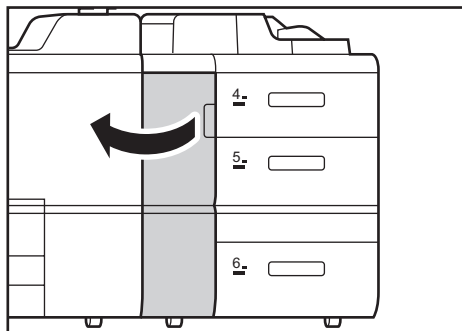

CZC015

2. Pull open the tray until it stops.

Remove any paper in the tray.

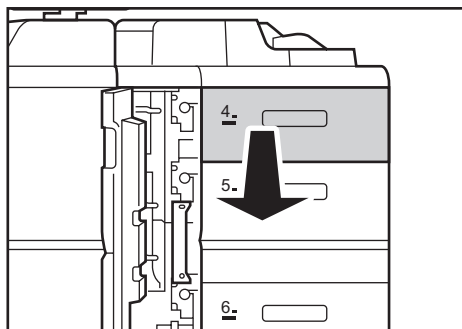

CZC016

3. Remove the 2 screws, and then remove the side plate.

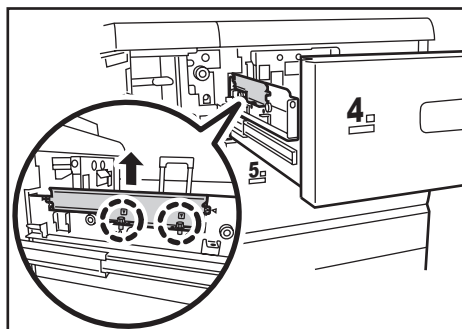

CZC017

4. Remove the 2 screws, and then pull out the paper feed unit until it stops.

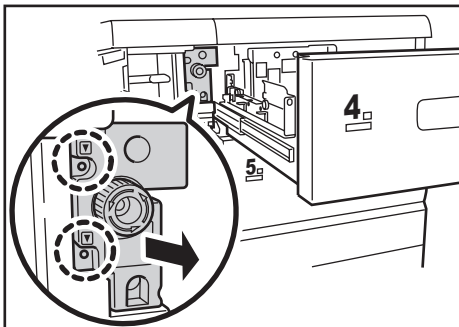

CZC018

5. Remove the screw, and then slide the bracket.

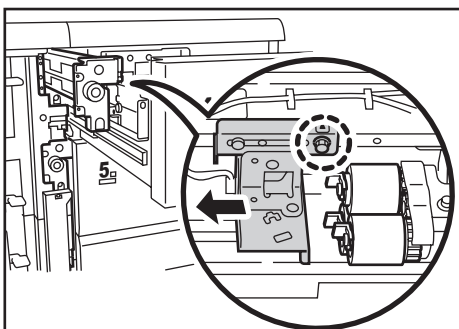

CZC019

6. Remove the paper feed roller in the following order:

- (1) Snap ring and pick-up roller
- (2) Snap ring and feed roller
- (3) Snap ring and separation roller

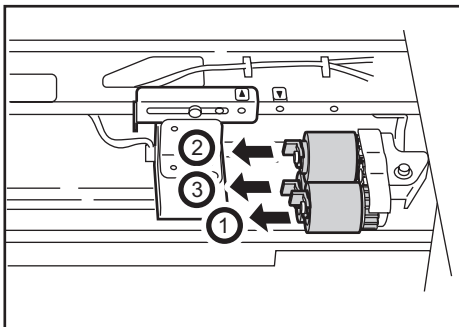

CZC189

7. Attach the new paper feed roller in the following order:

- (1) Separation roller and snap ring
- (2) Feed roller and snap ring

(3) Pick-up roller and snap ring

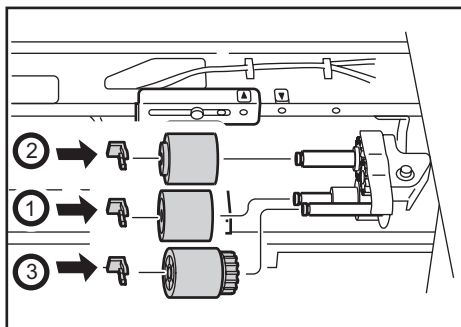

CZC157

8. Slide the bracket back to its original position, and then secure it with the screw.

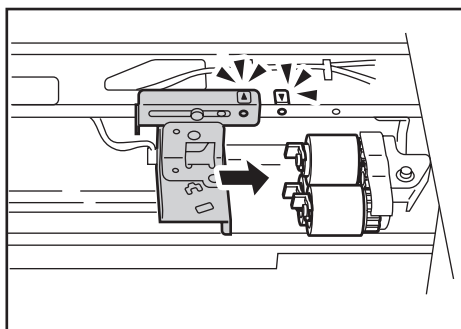

CZC024

9. Push the paper feed unit into the machine, and then secure it with the 2 screws.

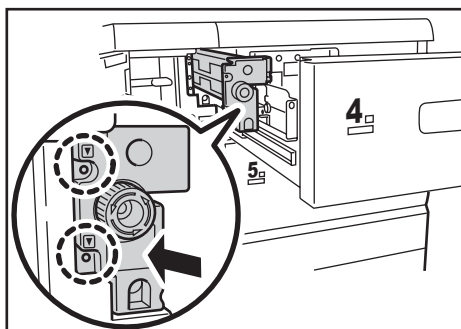

CZC023

10. Align the markers, and then secure the side plate with the 2 screws.

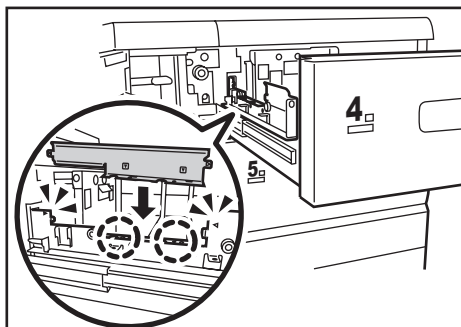

CZC022

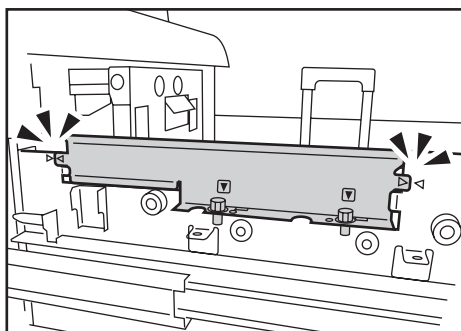

CZC156

11. Push the tray back into the machine.

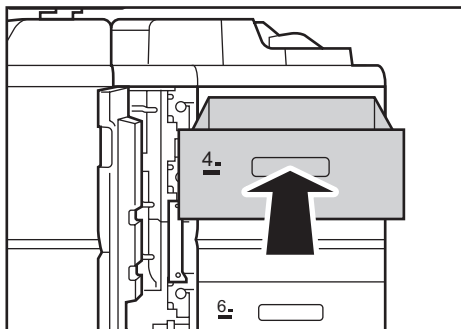

CZC021

12. Close the front cover.

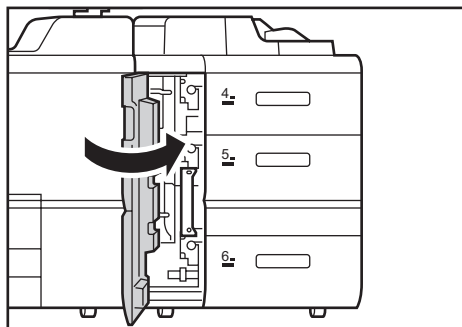

CZC020

13. Reset the counter for replaceable parts.

Do not turn the machine on until you have read how to do so.

See page 22 "Resetting the Replaceable Parts Counter".

Replacing the Rollers in the Wide LCT 5/6

1. Open the front cover.

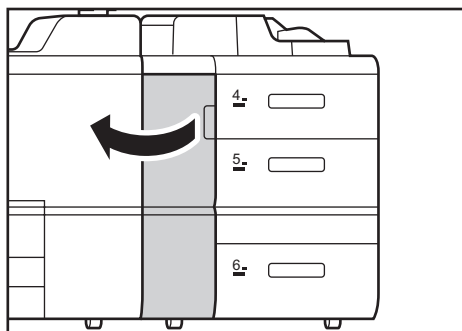

CZC015

2. Remove the tab paper end fence.

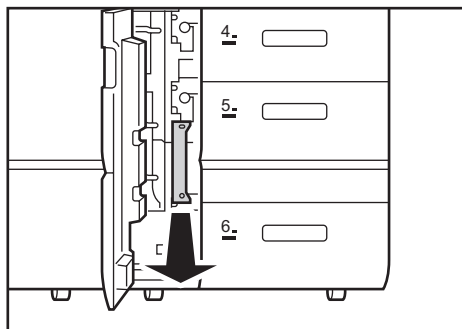

CZC025

3. Pull open the tray until it stops.

Remove any paper in the tray.

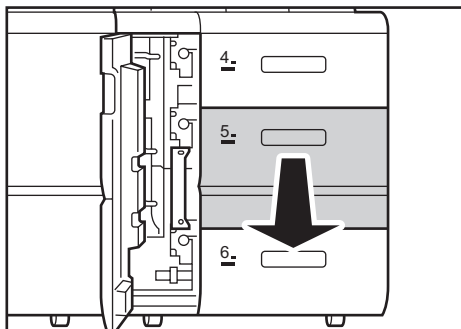

CZC026

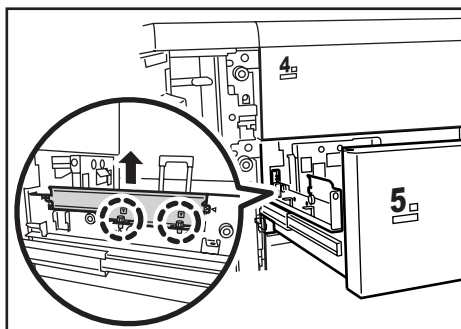
4. Remove the 2 screws, and then remove the side plate.

CZC151

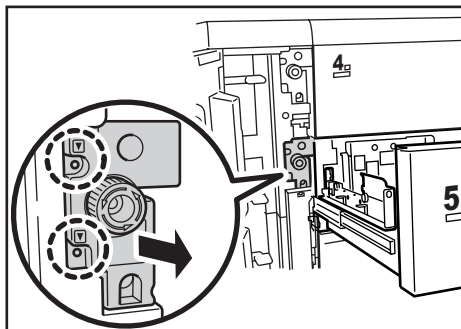
5. Remove the 2 screws, and then pull out the paper feed unit until it stops.

CZC152

6. Remove the screw, and then slide the bracket.

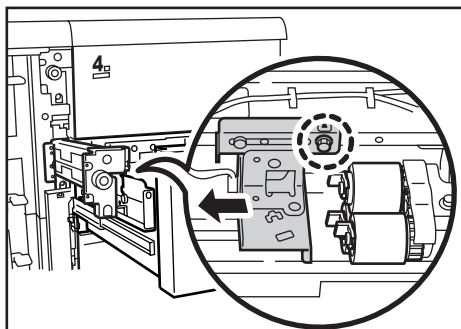

CZC183

7. Remove the paper feed roller in the following order:

- (1) Snap ring and pick-up roller
- (2) Snap ring and feed roller
- (3) Snap ring and separation roller

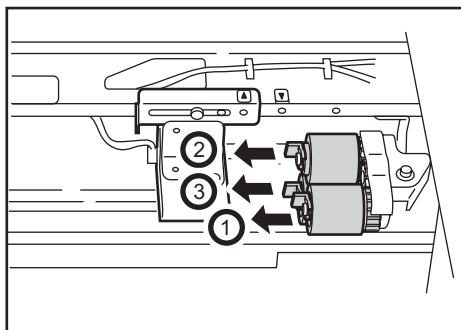

CZC189

8. Attach the new paper feed roller in the following order:

- (1) Separation roller and snap ring
- (2) Feed roller and snap ring
- (3) Pick-up roller and snap ring

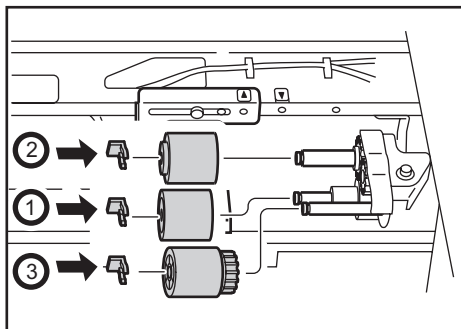

CZC157

9. Slide the bracket back to its original position, and then secure it with the screw.

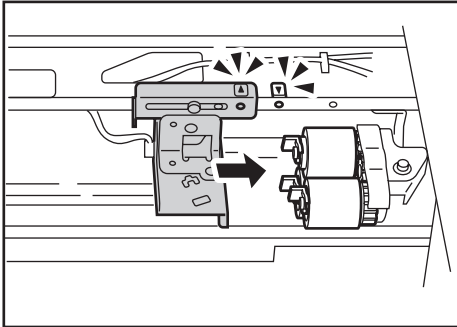

CZC024

10. Push the paper feed unit into the machine, and then secure it with the 2 screws.

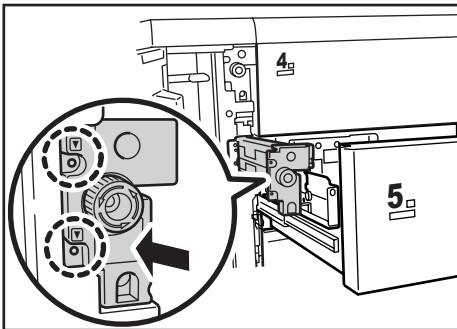

CZC154

11. Align the markers, and then secure the side plate with the 2 screws.

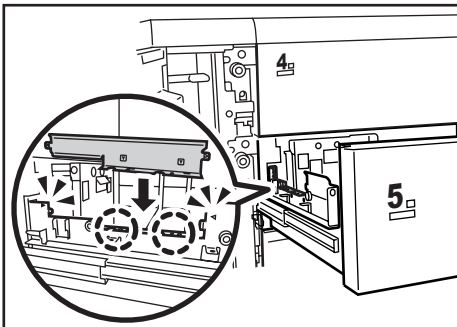

CZC153

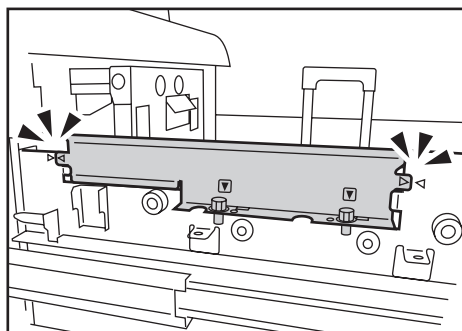

CZC156

12. Push the tray back into the machine.

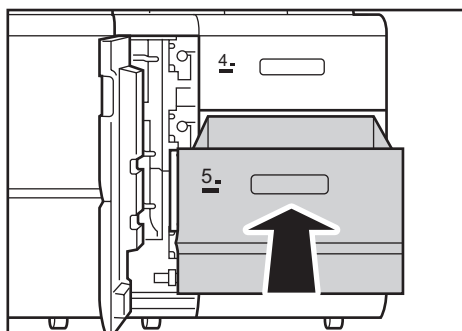

CZC028

13. Attach the tab paper end fence.

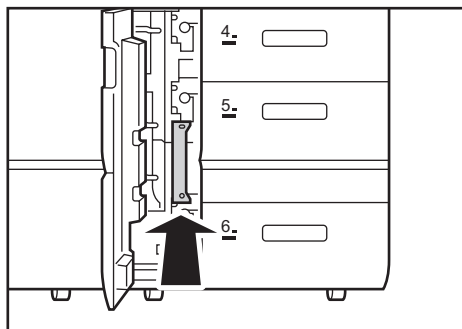

CZC027

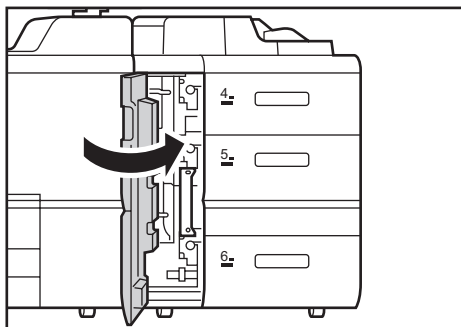
14. Close the front cover.

CZC020

15. Reset the counter for replaceable parts.

Do not turn the machine on until you have read how to do so.

See page 22 "Resetting the Replaceable Parts Counter".

Replacing the Rollers in the LCT

Replacing the Rollers in the LCT 4

2

1. Open the front cover.

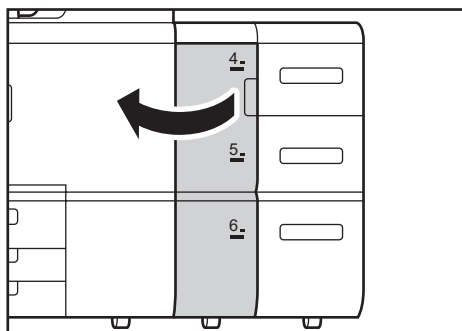

CZC029

2. Pull open the tray until it stops.

Remove any paper in the tray.

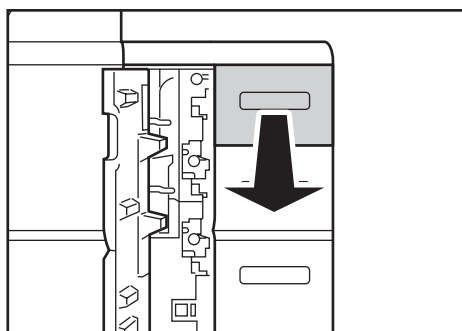

CZC030

3. Remove the 4 screws.

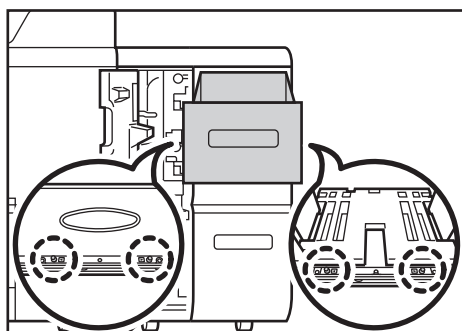

ECG047

4. Slip your hand into the opening on the left side, grasp the handle, and remove the inner tray.

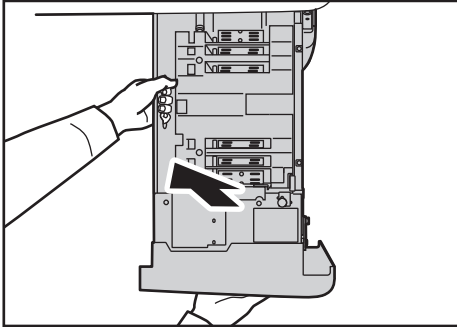

ECG046

5. Push the guide back into the machine.

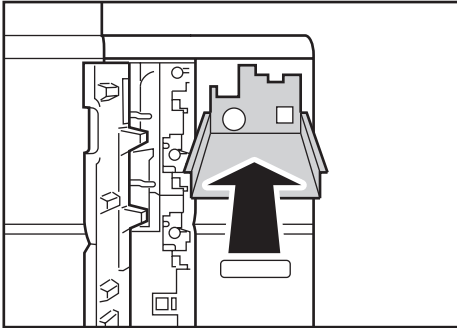

CZC032

6. Remove the paper feed roller in the following order:

- (1) Snap ring and pick-up roller
- (2) Snap ring and feed roller
- (3) Snap ring and separation roller

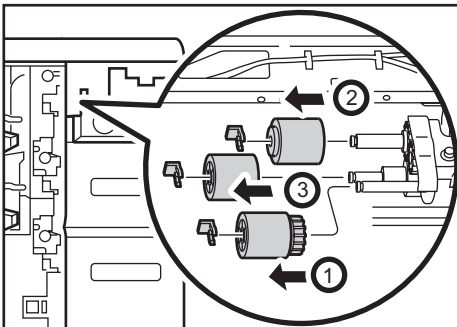

CZC033

7. Attach the new paper feed roller in the following order:

- (1) Separation roller and snap ring

(2) Feed roller and snap ring

(3) Pick-up roller and snap ring

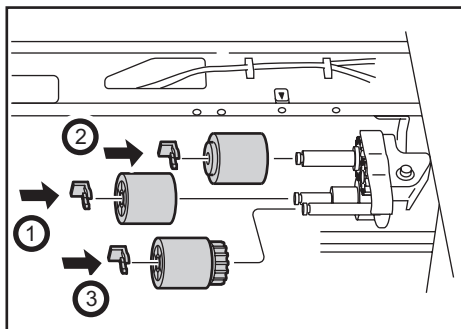

CZC038

8. Pull out the guide.

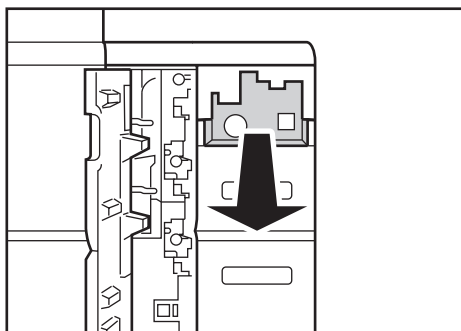

CZC037

9. Mount the inner tray on the guide.

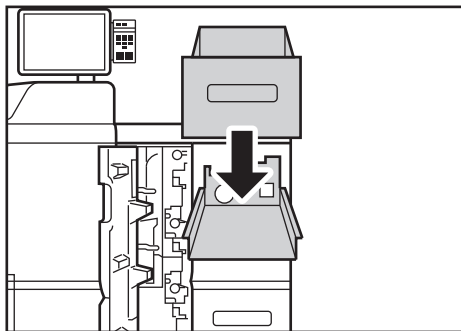

ECG048

10. Holding the bottom plate of the guide down to keep it from moving, push the inner tray forward to align it with the screw holes.

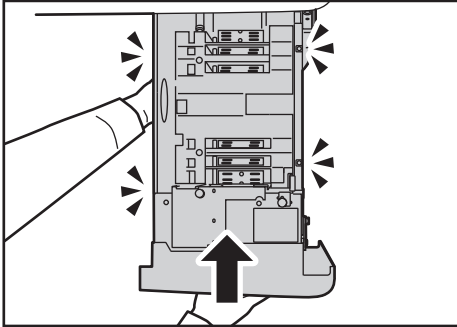

ECG049

11. Secure the tray with the 2 screws.

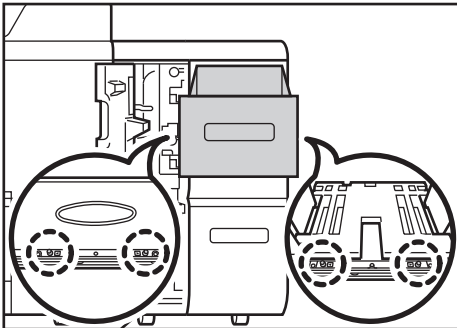

ECG047

12. Push the tray back into the machine.

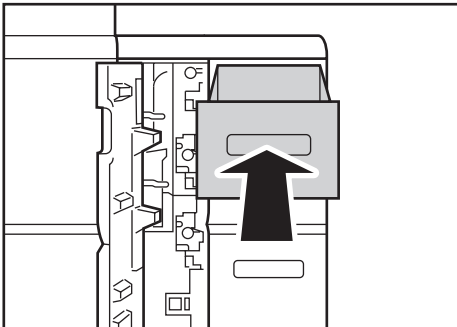

CZC035

13. Close the front cover.

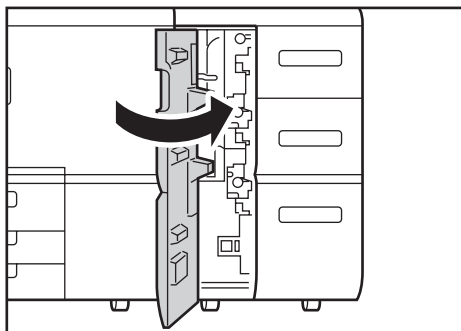

CZC034

14. Reset the counter for replaceable parts.

Do not turn the machine on until you have read how to do so.

See page 22 "Resetting the Replaceable Parts Counter".

Replacing the Rollers in the LCT 5

1. Open the front cover.

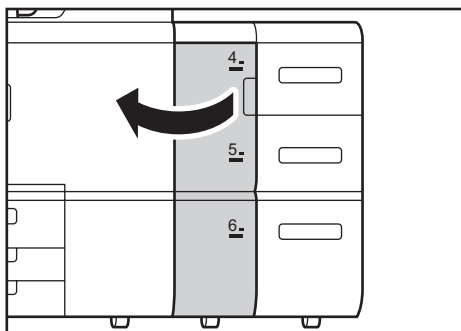

CZC029

2. Pull open the tray until it stops.

Remove any paper in the tray.

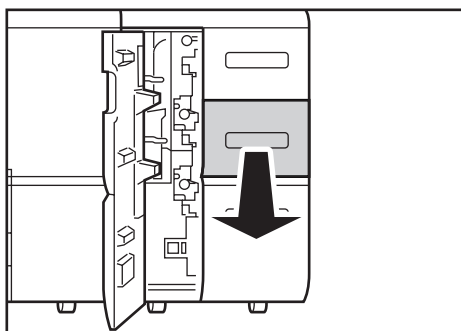

CZC039

3. Remove the 4 screws, and then remove the side plate.

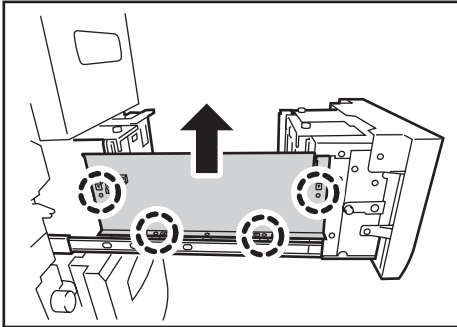

CZC040

4. Remove the 2 screws, and then pull out the paper feed unit until it stops.

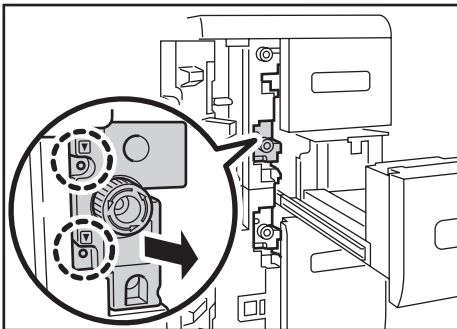

CZC041

5. Remove the paper feed roller in the following order:

- (1) Snap ring and pick-up roller
- (2) Snap ring and feed roller
- (3) Snap ring and separation roller

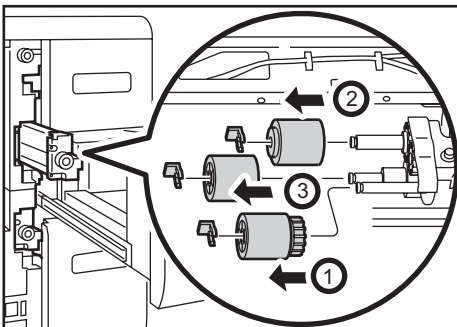

CZC184

6. Attach the new paper feed roller in the following order:

- (1) Separation roller and snap ring
- (2) Feed roller and snap ring

(3) Pick-up roller and snap ring

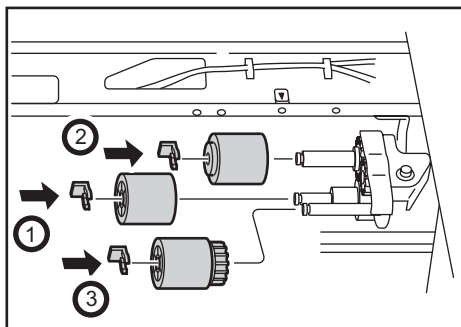

CZC038

7. Push the paper feed unit into the machine, and then secure it with the 2 screws.

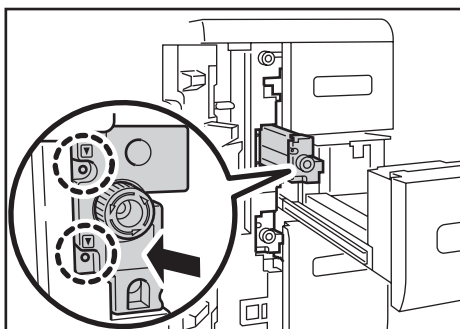

CZC044

8. Align the markers, and then secure the side plate with the 4 screws.

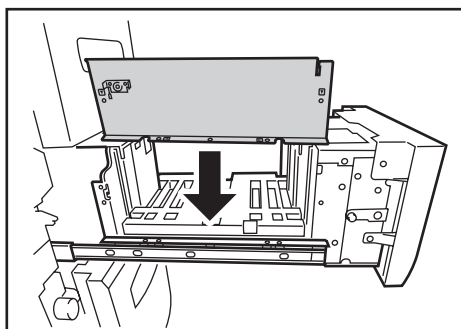

CZC043

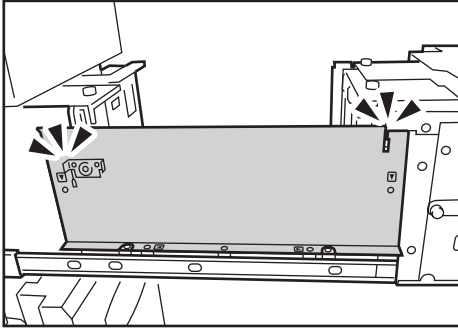

9. Push the tray back into the machine.

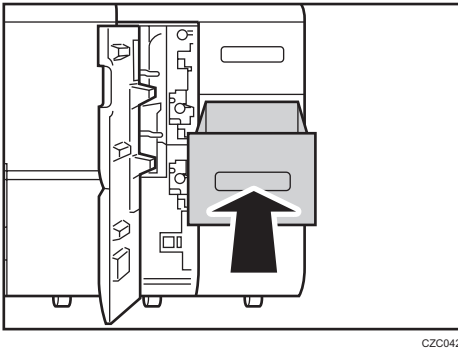

10. Close the front cover.

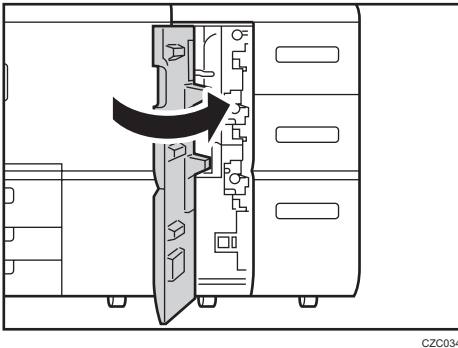

11. Reset the counter for replaceable parts.

Do not turn the machine on until you have read how to do so.

See page 22 "Resetting the Replaceable Parts Counter".

Replacing the Rollers in the LCT 6

1. Open the front cover.

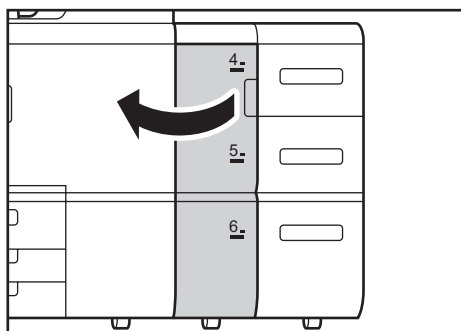

CZC029

2. Remove the tab paper end fence.

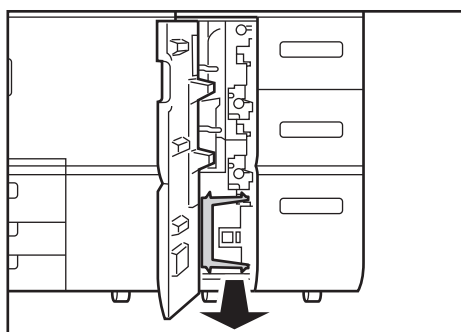

ECG050

3. Pull open the tray until it stops.

Remove any paper in the tray.

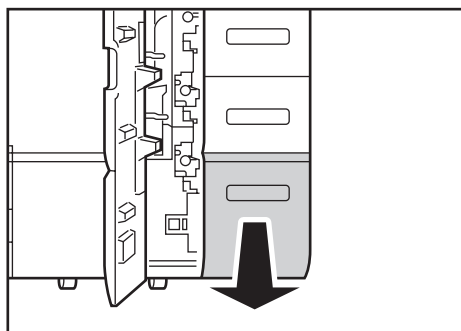

CZC045

4. Remove the 6 screws, and then remove the side plate.

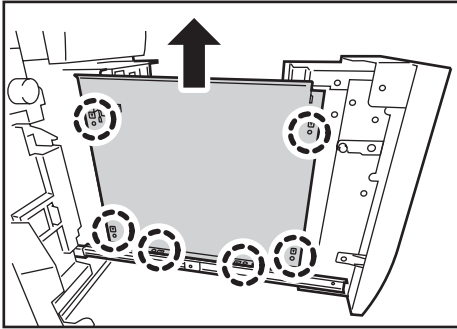

CZC046

5. Remove the 2 screws, and then pull out the paper feed unit until it stops.

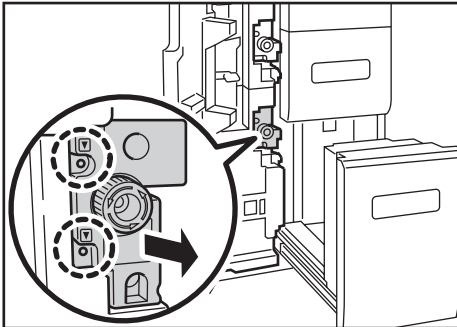

CZC047

6. Remove the paper feed roller in the following order:

- (1) Snap ring and pick-up roller
- (2) Snap ring and feed roller
- (3) Snap ring and separation roller

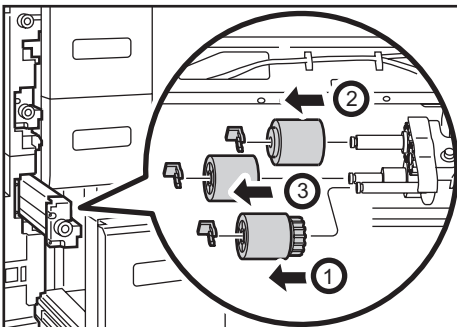

CZC185

7. Attach the new paper feed roller in the following order:

- (1) Separation roller and Snap ring
- (2) Feed roller and Snap ring

(3) Pick-up roller and Snap ring

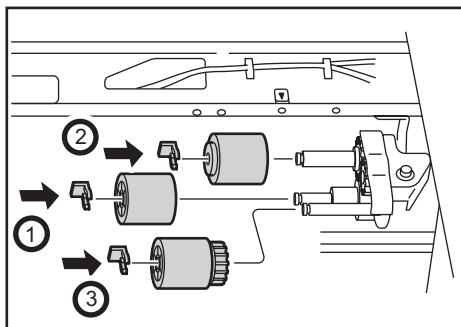

CZC038

8. Push the paper feed unit into the machine, and then secure it with the 2 screws.

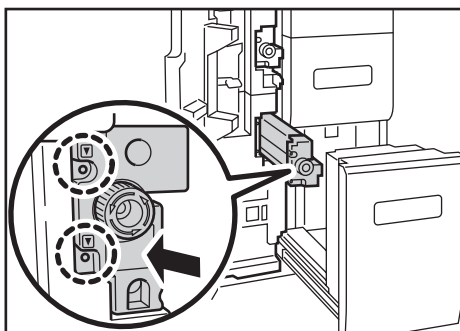

CZC050

9. Align the markers, and then secure the side plate with the 6 screws.

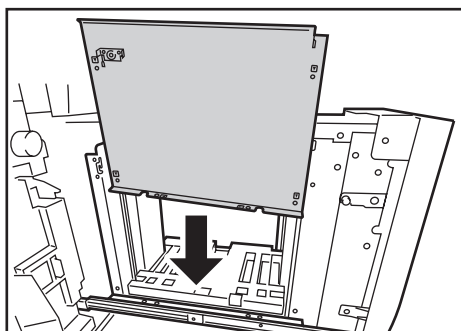

CZC049

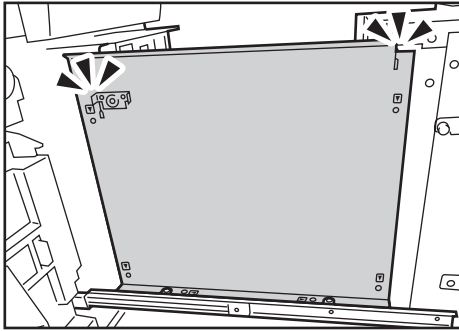

10. Push the tray back into the machine.

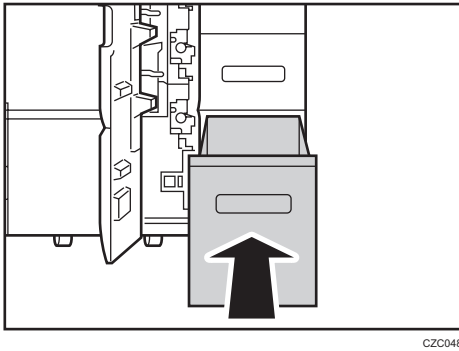

11. Attach the tab paper end fence.

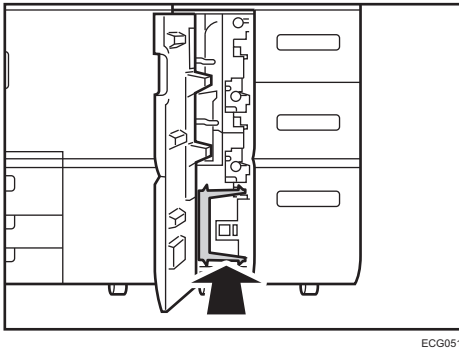

12. Close the front cover.

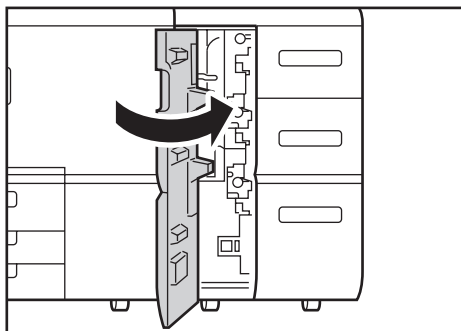

CZC034

13. Reset the counter for replaceable parts.

Do not turn the machine on until you have read how to do so.

See page 22 "Resetting the Replaceable Parts Counter".

Replacing the Rollers in the Bypass Tray

1. Remove the cover.

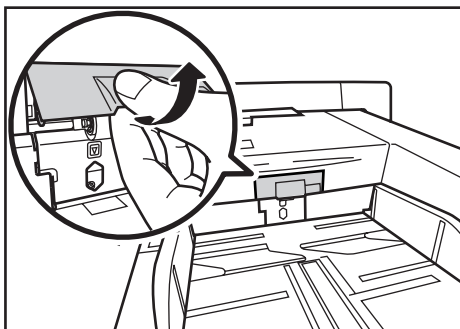

CZC128

2. Remove the screw.

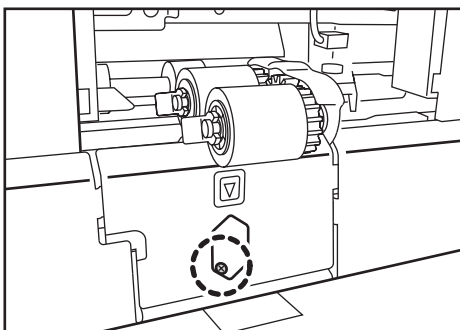

CZC124

3. Remove the plate.

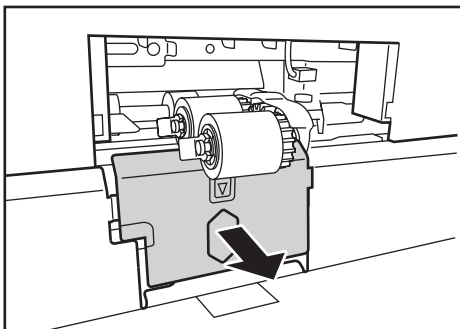

CZC129

4. Remove the screw, and then slide the bracket.

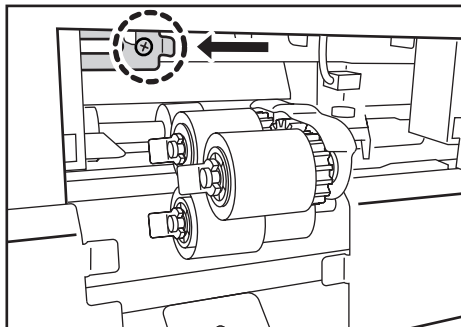

CZC125

5. Remove the paper feed roller in the following order:

- (1) Snap ring and pick-up roller
- (2) Snap ring and feed roller
- (3) Snap ring and separation roller

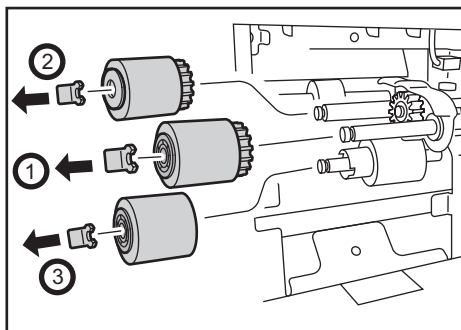

CZC132

6. Attach the new paper feed roller in the following order:

- (1) Separation roller and Snap ring
- (2) Feed roller and Snap ring
- (3) Pick-up roller and Snap ring

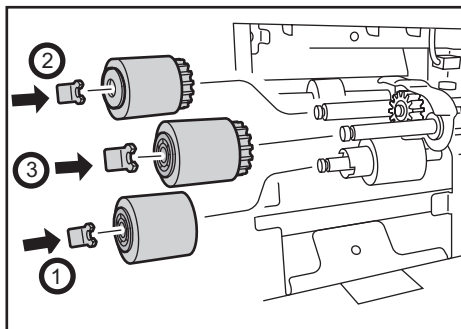

CZC133

7. Slide the bracket back to its original position, and then secure it with the screw.

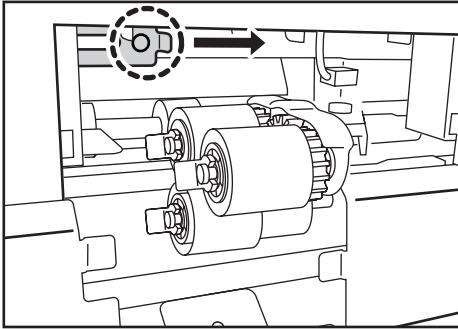

CZC126

8. Attach the plate.

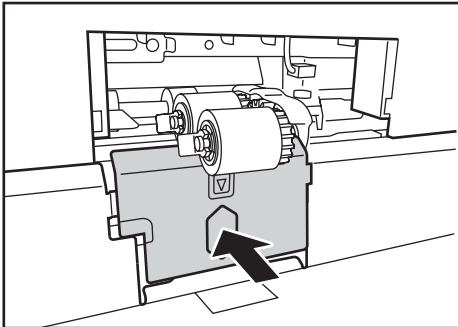

CZC130

9. Secure the plate with the screw.

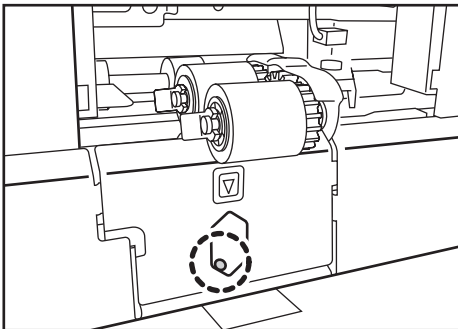

CZC127

10. Attach the cover.

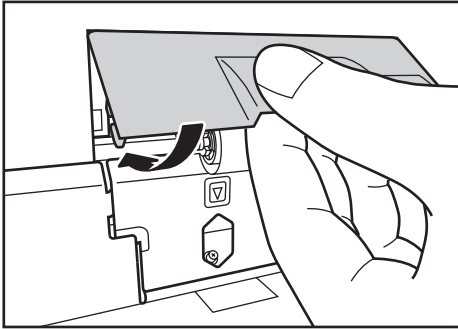

CZC131

11. Reset the counter for replaceable parts.

Do not turn the machine on until you have read how to do so.

See page 22 "Resetting the Replaceable Parts Counter".

Replacing the Rollers in the ADF

Available rollers are Pro 8300S, Pro 8310S, and Pro 8320S.

1. Open the ADF cover.

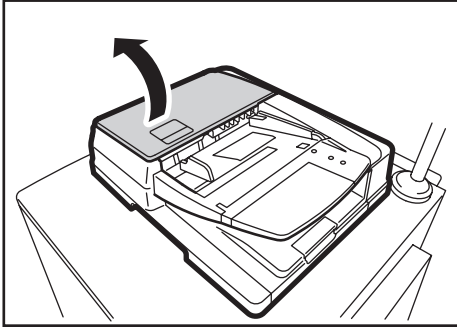

CWH133

2. Remove the retaining plate.

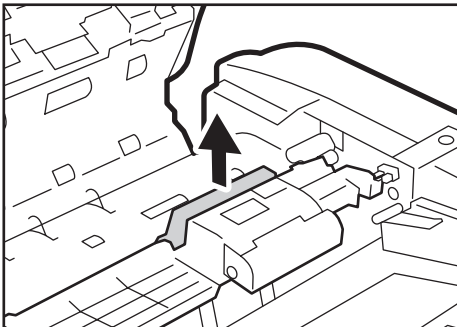

CZC160

3. Pull the shaft toward the front of the machine to detach it, and then remove the paper feed unit.

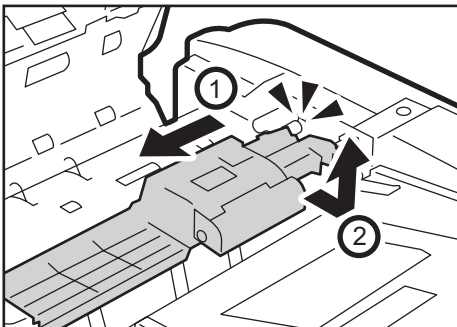

CZC161

4. Remove the separation roller cover.

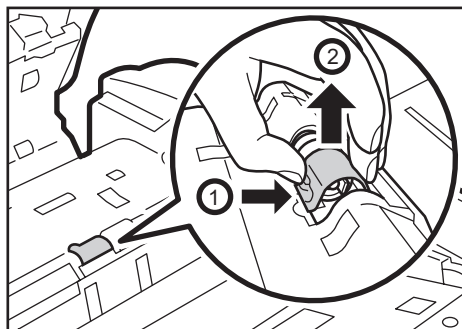

CZC162

5. Remove the separation snap ring and roller.

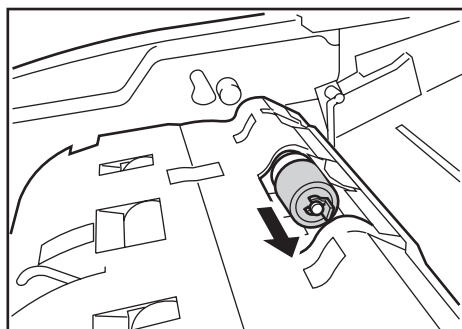

CWH136

6. Mount the new separation roller and the snap ring.

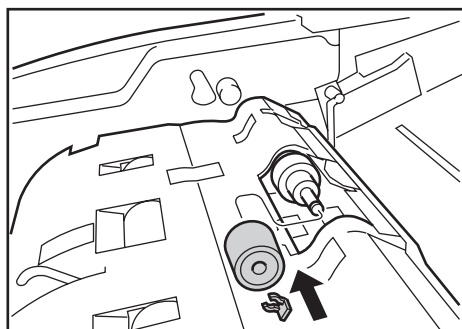

CWH137

When you replace the parts, be careful not to bend the film.

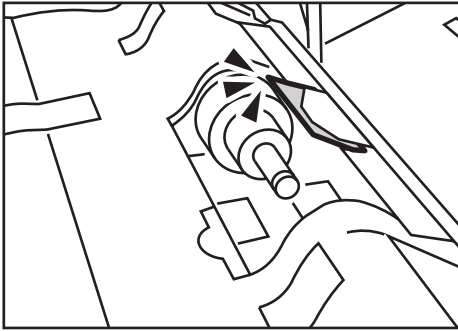

CZC194

- 7. Attach the separation roller cover by aligning the tabs.**

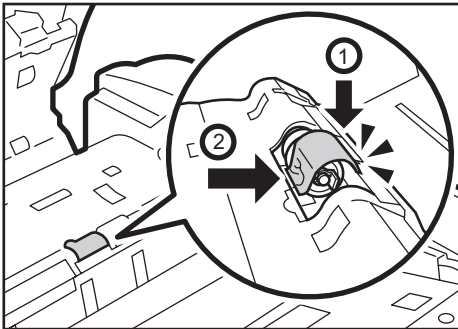

CZC163

- 8. Remove the two pick-up roller's snap rings and bearings, and then remove the pick-up roller cover.**

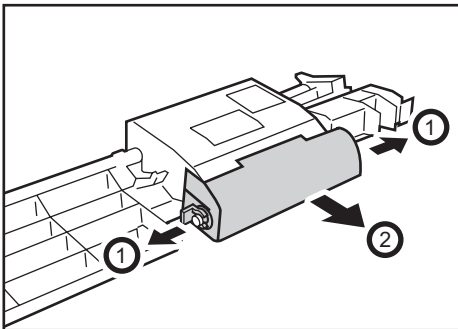

DTH001

9. Disengage the shaft, remove the white component, and then remove the pick-up roller.

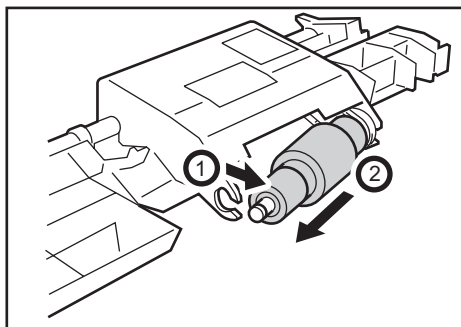

CWH140

10. Mount the new pick-up roller and reattach the white component and the shaft.

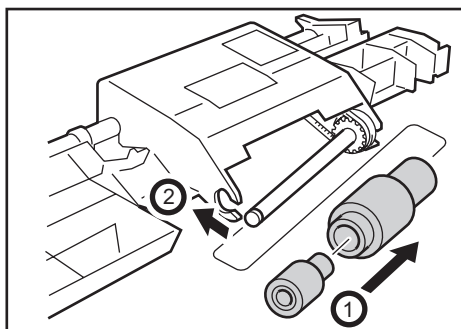

CWH141

11. Attach the cover, and then fit the two bearings and snap rings.

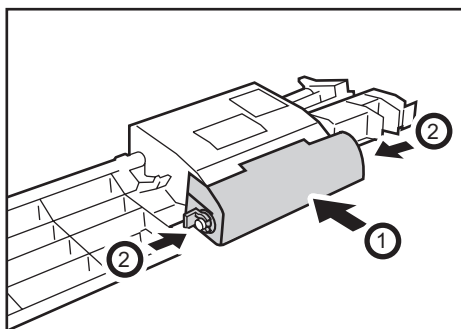

DTH002

- 12. Pulling the white component away, disengage the projecting part from the pick-up roller.**

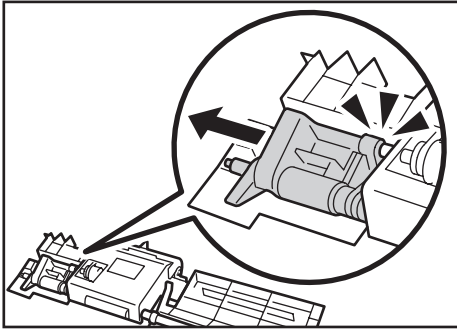

CZC175

- 13. Remove the component containing the pick-up roller.**

Be sure to disengage the projecting part before removing the component. If you try to remove it forcefully, you may damage it.

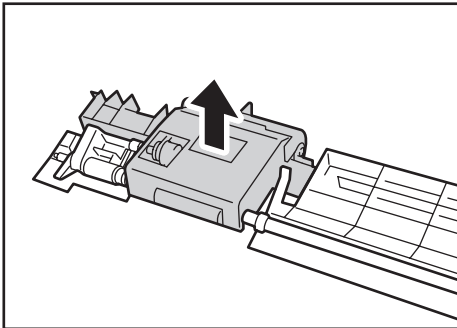

CZC176

- 14. Remove the paper feed belt cover.**

The paper feed belt cover's spring comes off easily. Be careful not to lose it.

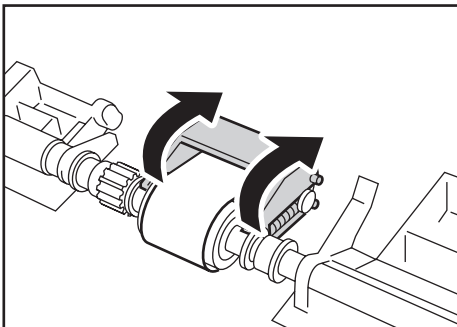

CZC177

15. Remove the idler roller and the paper feed belt.

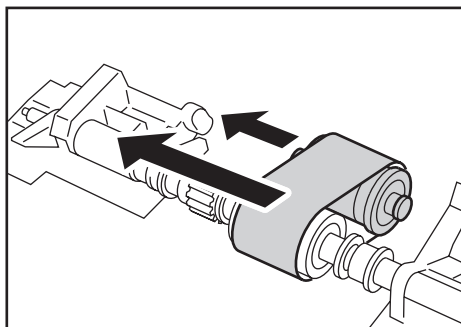

CWH145

16. Install the new paper feed belt and reattach the idler roller.

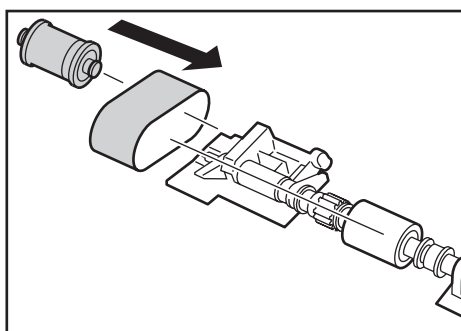

CWH146

17. Insert the cover's bars into the holes in the idler roller's shaft.

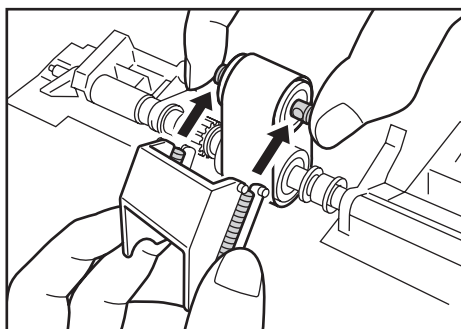

CZC178

18. Attach the paper feed belt cover.

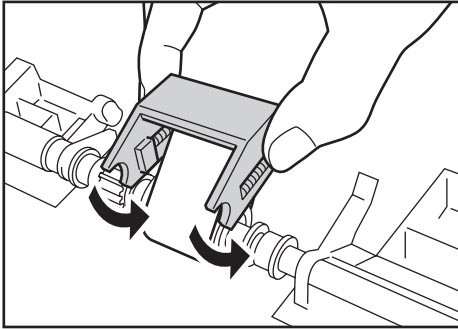

CZC180

19. Attach the component containing the pick-up roller.

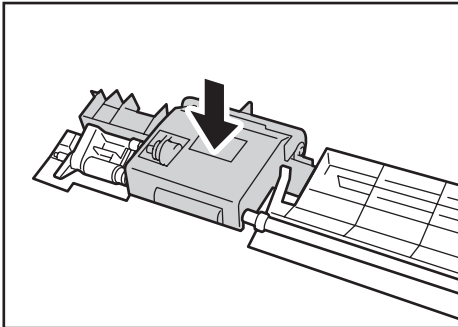

CZC179

20. Pull the white component and insert the stud into the component containing the pick-up roller.

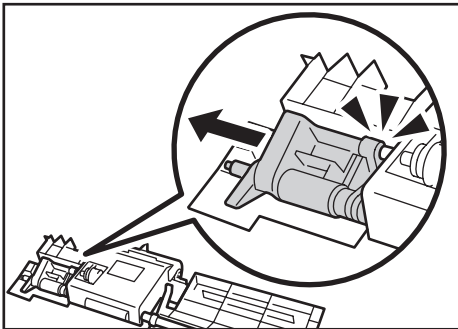

CZC175

21. Insert the end of the shaft into the hole.

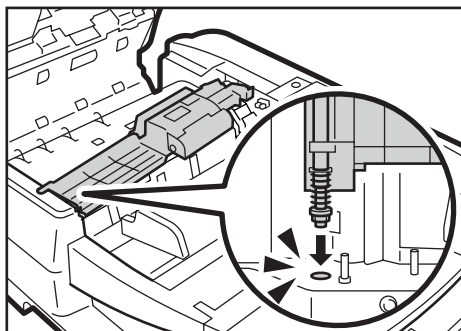

CZC181

22. Install the paper feed unit by inserting the end of the shaft into the socket in the white component, making sure that the end of the shaft and the socket have the same cross-sectional shape.

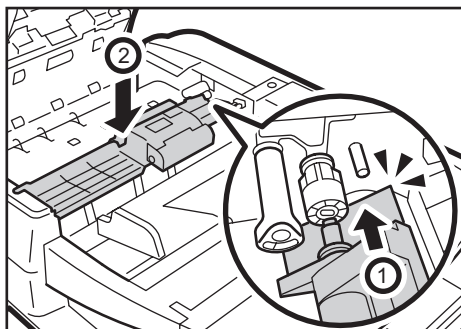

CZC182

23. Reattach the stopper.

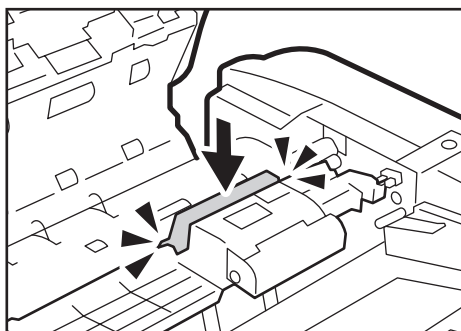

CZC165

24. Close the ADF cover.

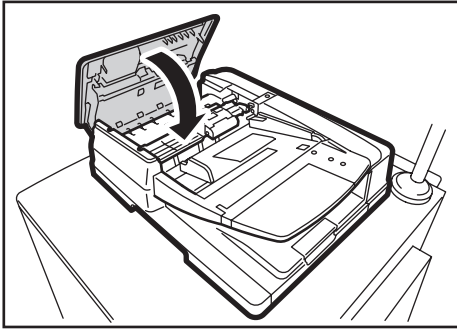

CWH151

25. Reset the counter for replaceable parts.

Do not turn the machine on until you have read how to do so.

See page 22 "Resetting the Replaceable Parts Counter".

3. Development Unit

Before You Begin

★ Important

- The surface of a drum is sensitive to light. Exposing the surface of a drum to strong light (especially direct sunlight) can permanently damage it.
- Replace the photoconductor unit or its cleaning unit with the detached charge unit.

What You Need

- Hex screwdriver
- Drum setting powder pad applicator
- Newspaper or other paper

Time for Replacement

A message will appear when it nears the time to replace a component.

Print the counter list.

1. Press [Counter] at the bottom of the screen in the right.
2. To print a counter list, press [Print Counter List], and then press the [Start] key.
3. Press [Exit].

Replaceable Parts

Charger unit

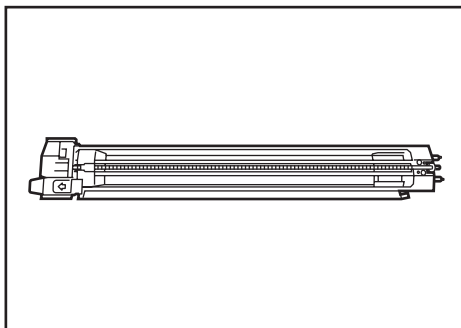

CZC051

Cleaning unit for photoconductor unit

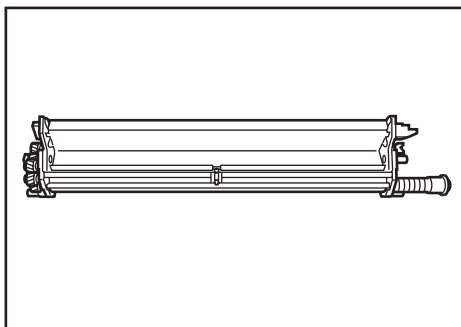

CZC052

Photoconductor unit

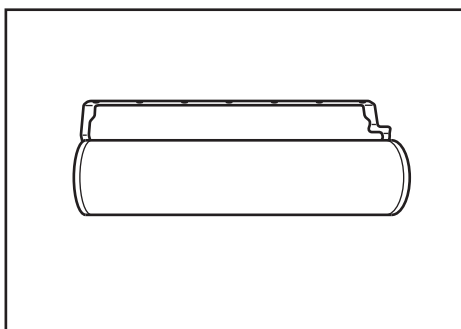

CZC053

Replacing the Charger Unit/Cleaning Unit for Photoconductor Unit/Photoconductor Unit

1. Open the front covers.

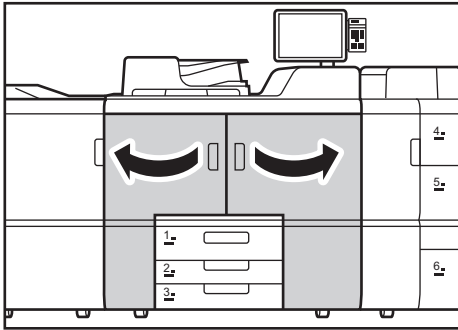

ECG006

2. Remove the 3 screws.

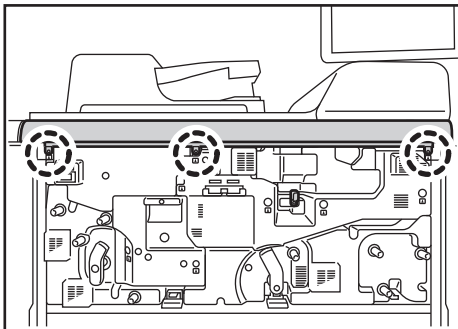

ECG019

3. Remove the cover.

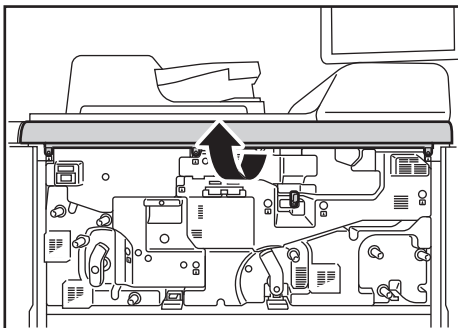

ECG020

4. Push the lock lever.

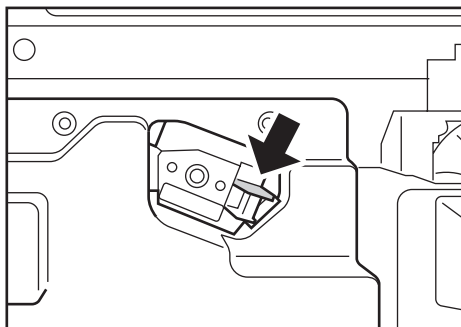

CZC056

5. Pulling the lock lever down, pull out the charger unit.

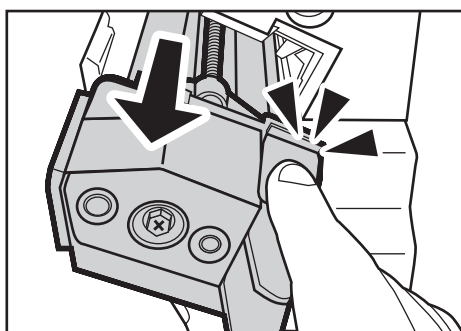

CZC166

6. Holding the lock lever and the outer metal frame of the charger unit, pull out the charger unit. Be careful not to touch the center metal portion of the unit.

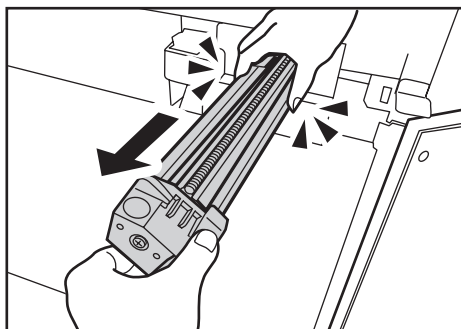

CZC167

7. Pull down the lever.

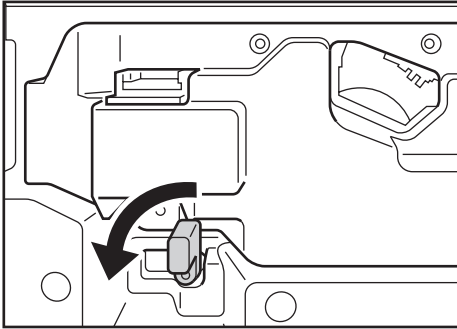

CZC057

8. Remove the 3 screws, and then remove the cover.

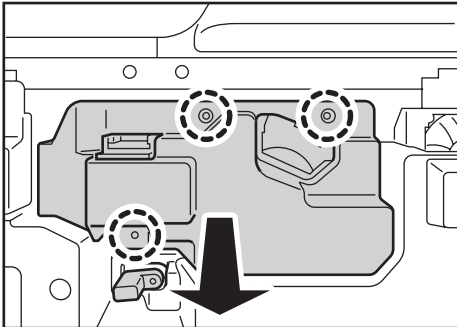

CZC058

9. Loosen the drawer stop knob by turning it, and then remove it.

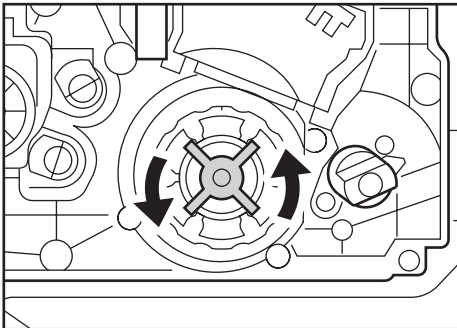

CZC059

- 10. Holding the handle, pull out the development unit drawer.**

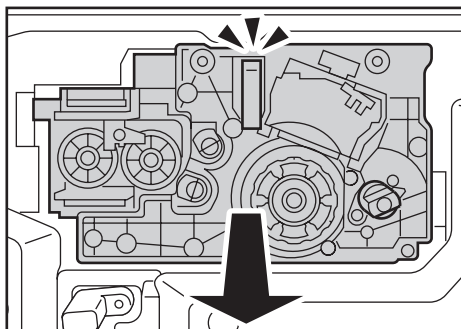

CZC060

- 11. Turn the lock lever.**

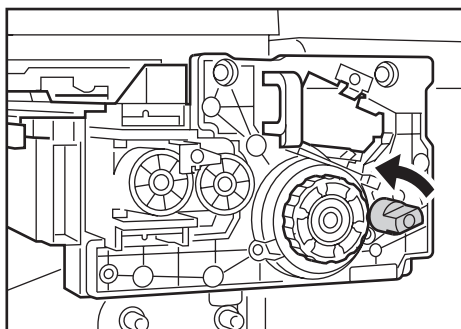

CZC061

- 12. Remove the cleaning unit for photoconductor unit.**

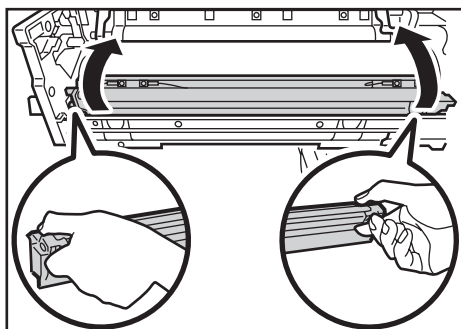

CZC062

13. Turn the drum knob.

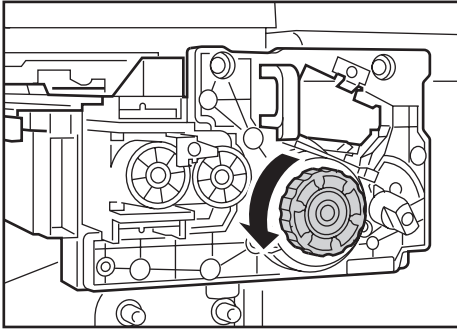

CZC063

14. Rotate the handle.

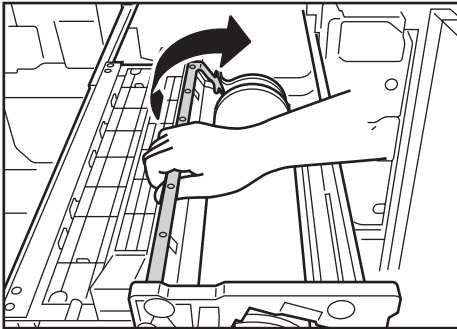

CZC064

15. Pull out the photoconductor unit.

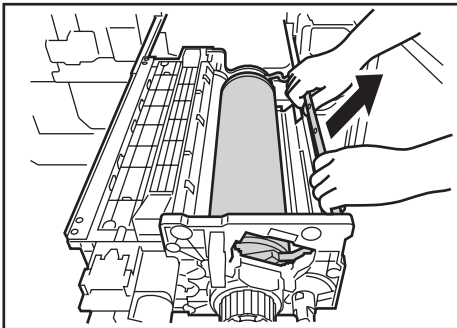

CZC065

16. Pat the surface of the photoconductor with a powder puff to apply powder.

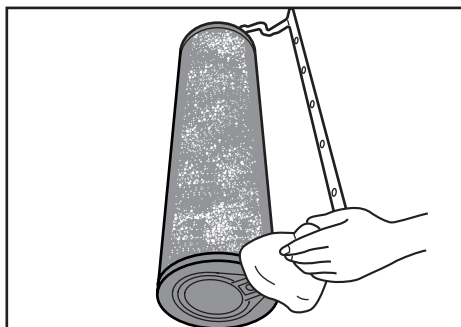

CZC145

17. Spread the powder on the photoconductor unit evenly using a dry cloth.

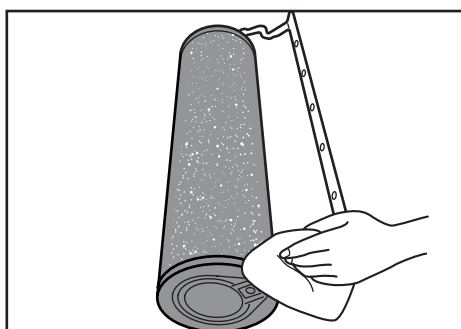

CZC174

18. Rotate the photoconductor unit a half-turn until the surface to which the powder has been applied faces down.

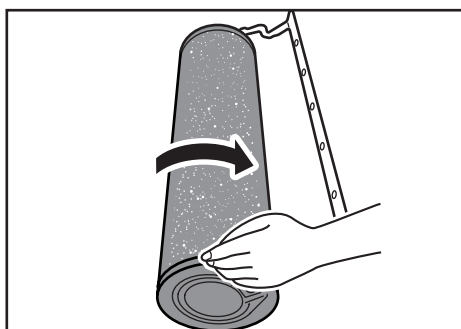

CZC196

19. Attach the new photoconductor unit.

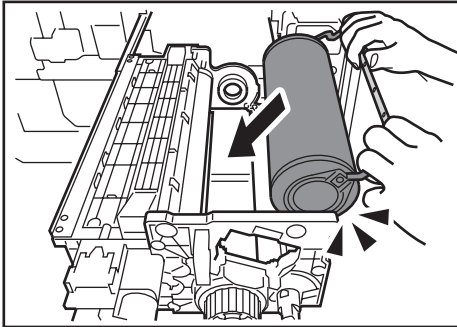

CZC077

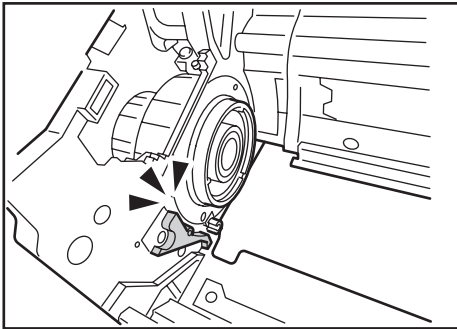

CZC147

Make sure that the surface to which the powder has been applied does not come into contact with the development roller.

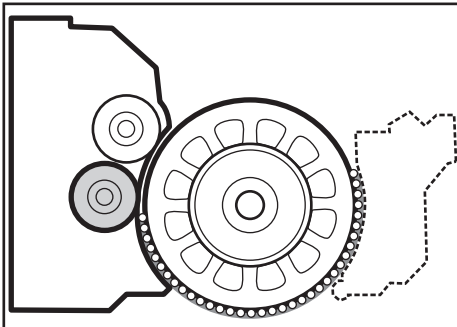

CZC197

20. Rotate the handle.

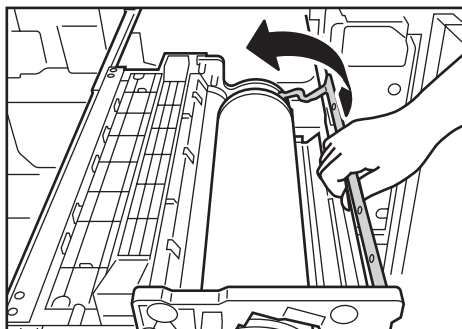

CZC076

21. Turn the drum knob while pushing it in to fasten the photoconductor unit.

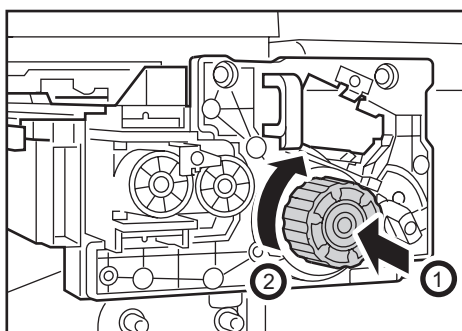

CZC075

22. Check that the drum knob is locked securely.

Turn the drum knob until the groove (2) reaches the position to the right of reference position (1).

Unlocked

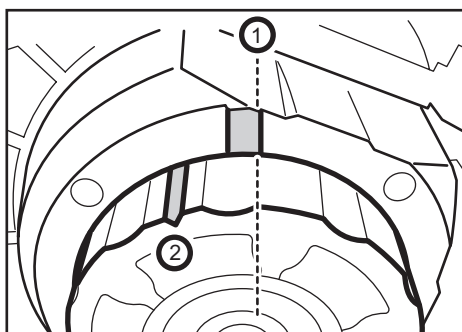

CZC187

Locked

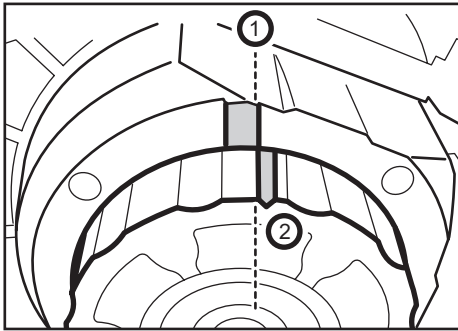

CZC190

3

23. Attach the new cleaning unit for photoconductor unit.

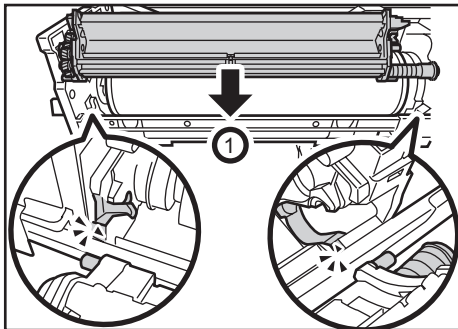

CZC074

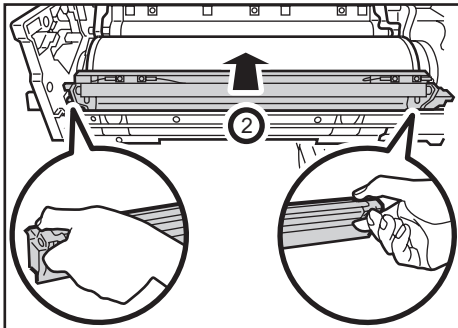

CZC169

- 24. Turn the lock lever, and then secure cleaning unit for photoconductor unit.**

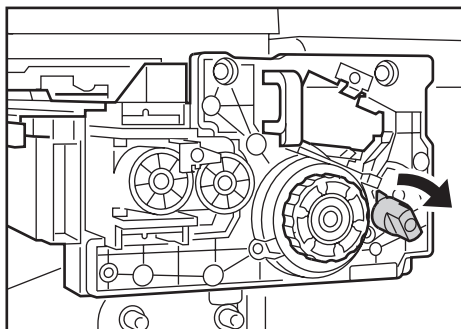

CZC073

- 25. While carefully holding the cleaning unit for photoconductor unit, rotate the photoconductor unit half a turn.**

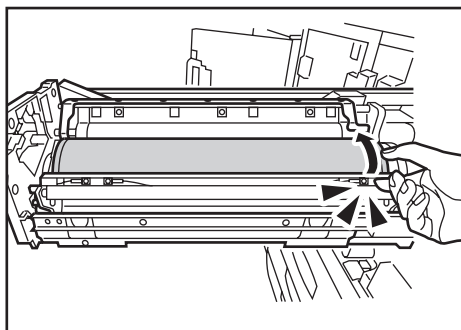

CZC148

- 26. Holding the handle, push the development unit drawer back into the machine.**

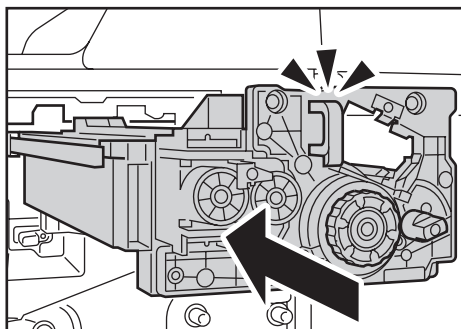

CZC072

27. Check that the development unit is attached securely.

Detached

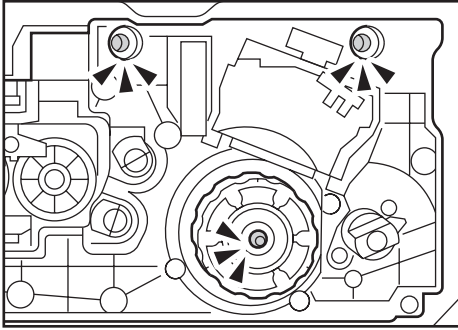

CZC188

Attached

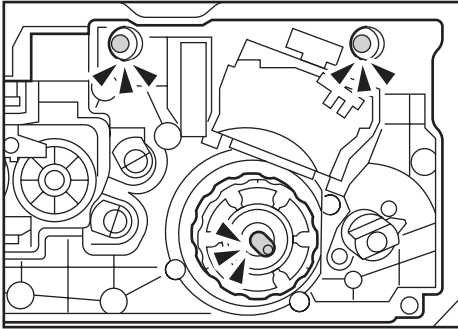

CZC191

28. Install the drawer stop knob, and then fasten it by turning it.

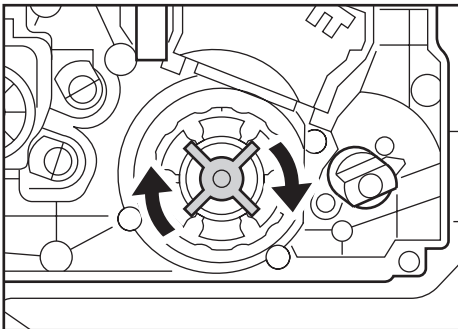

CZC071

29. Attach the cover, and then secure it with the 3 screws in order.

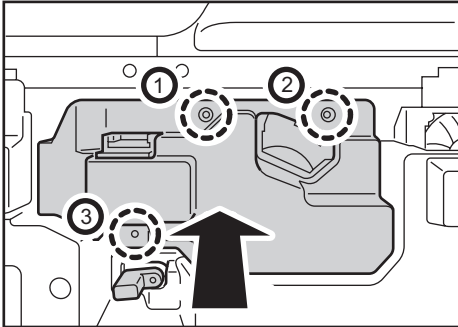

CZC070

30. Pull up the lever.

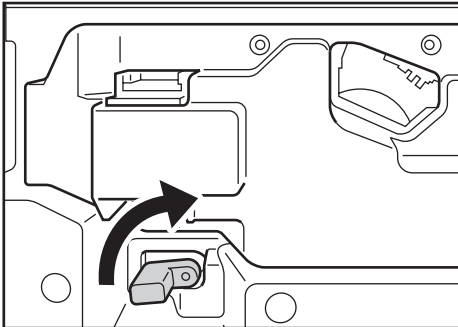

CZC069

★ Important

- Push up the lever as shown in the figure. An internal spring will return the lever to its original position. If the lever is held and turned, the roller may not return to the correct position, causing an error.

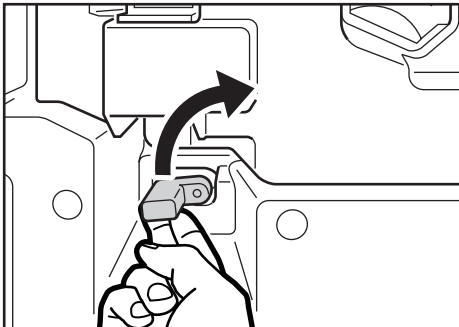

DTH003

- 31. Engage the new charger unit with the guide rail.**

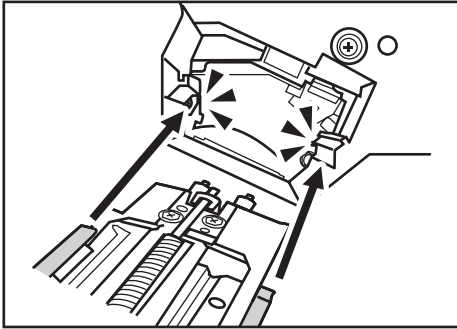

CZC168

- 32. Push the charger unit in horizontally.**

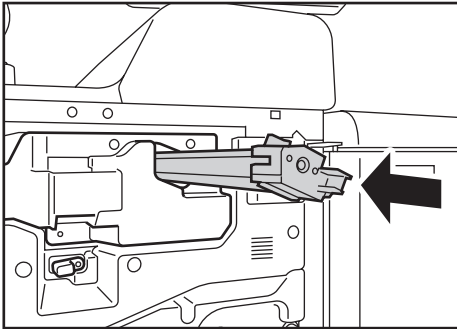

CZC068

- 33. Attach the cover by aligning it with the 3 catches.**

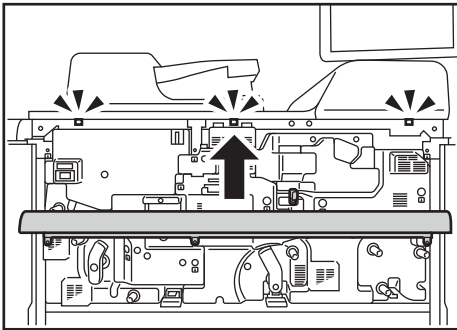

ECG022

34. Secure the cover with the 3 screws.

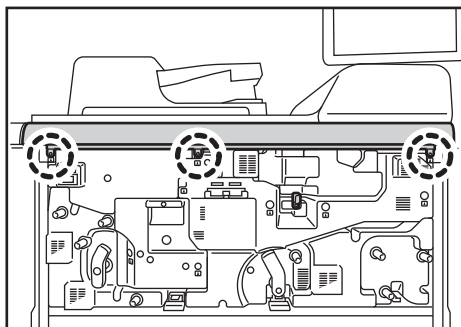

ECG021

35. Close the front covers.

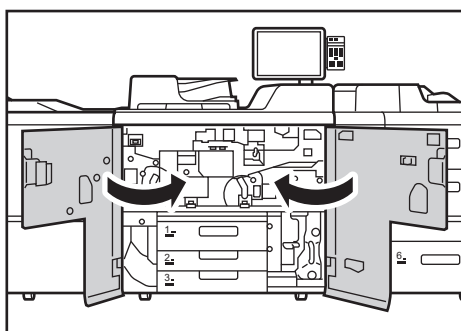

ECG007

36. Reset the counter for replaceable parts.

Do not turn the machine on until you have read how to do so.

See page 22 "Resetting the Replaceable Parts Counter".

4. Cleaning Unit for Image Transfer Belt

Before You Begin

★ Important

- The cleaning unit for image transfer belt requires lubrication as part of its replacement. Lubricate the cleaning unit for the photoconductor unit and image transfer belt that are detached.

What You Need

- Hex screwdriver
- Newspaper or other paper

Time for Replacement

A message will appear when it nears the time to replace a component.

Print the counter list.

1. Press [Counter] at the bottom of the screen in the right.
2. To print a counter list, press [Print Counter List], and then press the [Start] key.
3. Press [Exit].

Replaceable Parts

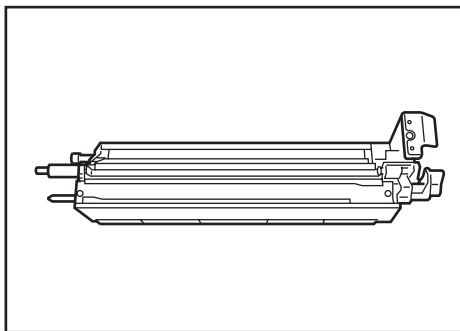

CZC078

Replacing the Cleaning Unit for Image Transfer Belt

1. Open the front covers.

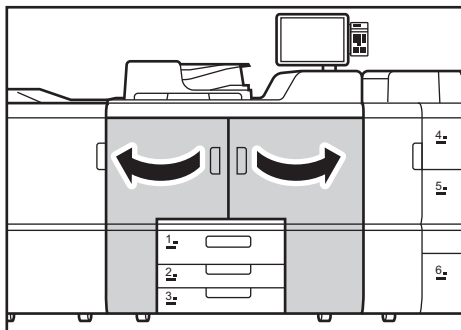

ECG006

2. Pull down the 2 levers.

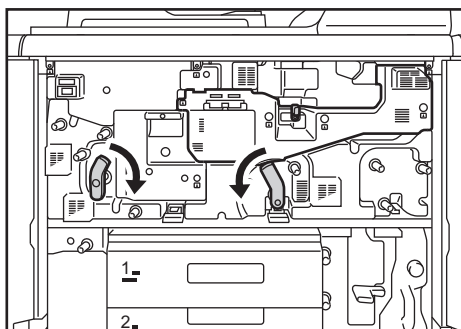

ECG062

3. Pull down the lever.

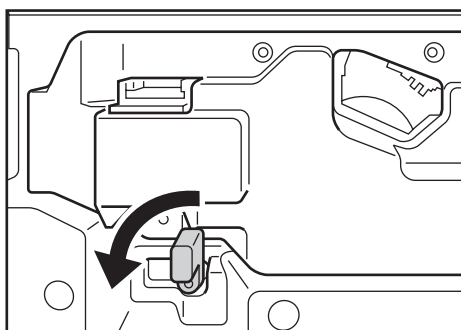

CZC057

4. Remove the 4 screws, and then remove the cover.

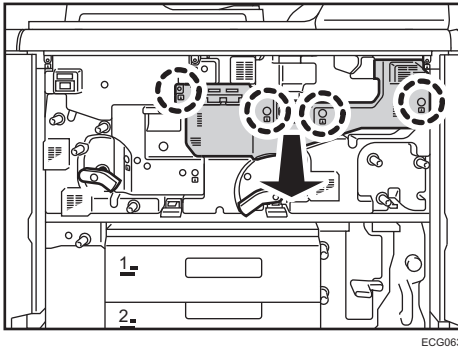

5. Pull out the drawer until it stops.

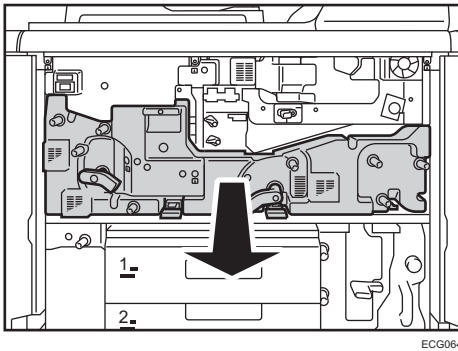

6. Remove the paper transfer unit.

See page 112 "Replacing the Paper Transfer Unit".

7. Spread a sheet of paper.

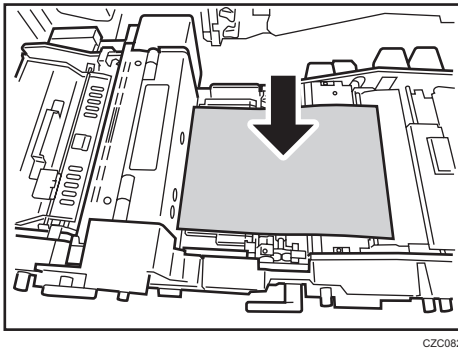

- 8. Push the drawer back into the machine.**

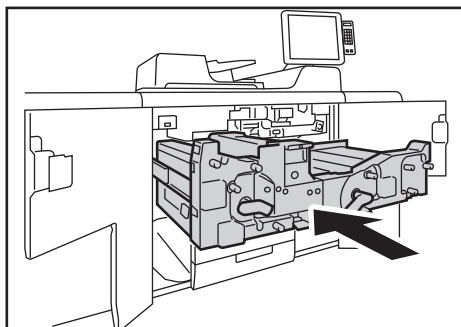

ECG023

4

- 9. Remove the cleaning unit for photoconductor unit.**

See page 85 "Replacing the Charger Unit/Cleaning Unit for Photoconductor Unit/Photoconductor Unit".

- 10. Pull up the 2 levers, and then remove the screw.**

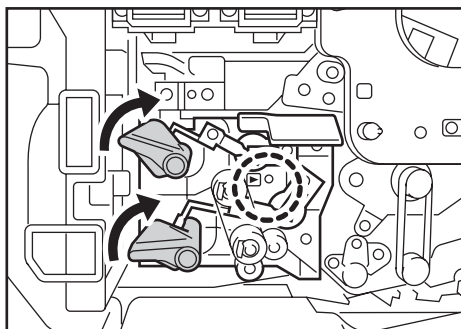

CZC083

- 11. Holding the grip, pull out the cleaning unit for image transfer belt while pressing it to the left.**

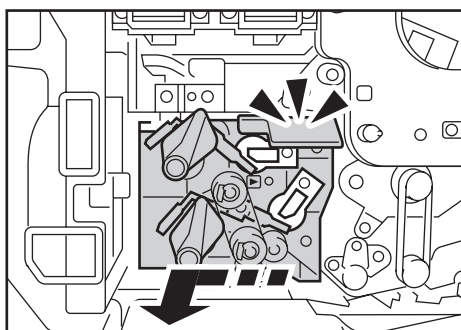

CZC084

12. Pull out the cleaning unit for image transfer belt until it stops.

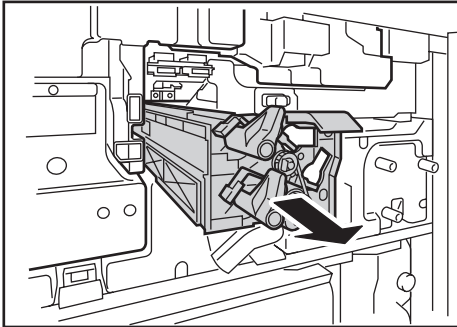

CZC170

13. While holding the latch, remove the cleaning unit for image transfer belt.

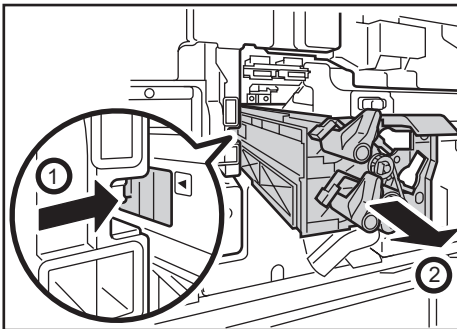

CZC085

14. Engage the new cleaning unit for image transfer belt with the guide rail.

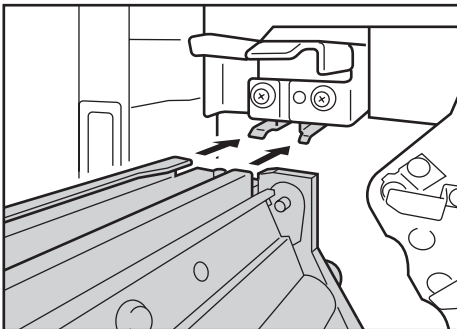

CZC091

15. Push in the cleaning unit for image transfer belt while pressing it to the left.

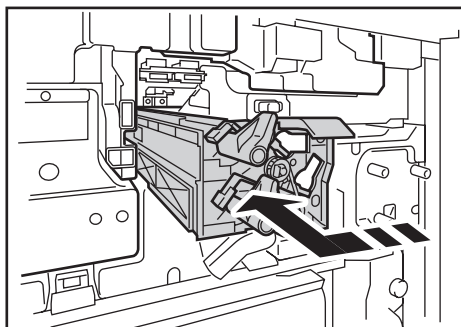

CZC092

4

16. Secure the cleaning unit for image transfer belt with the screw.

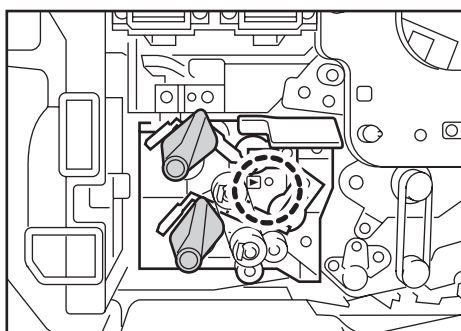

CZC195

17. Pull out the drawer until it stops.

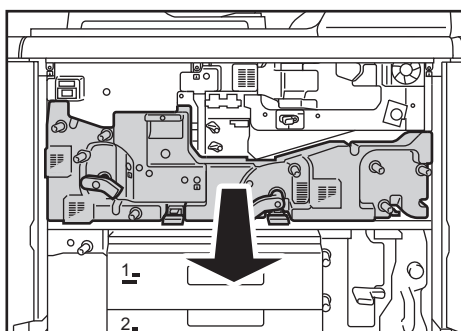

ECG064

18. Remove the paper.

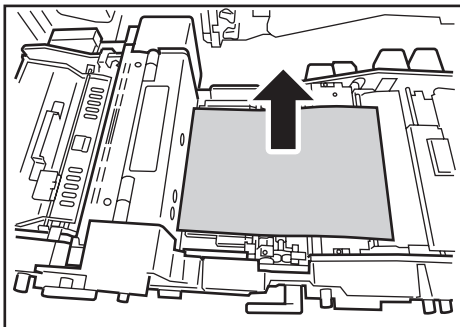

CZC089

19. Push the drawer back into the machine.

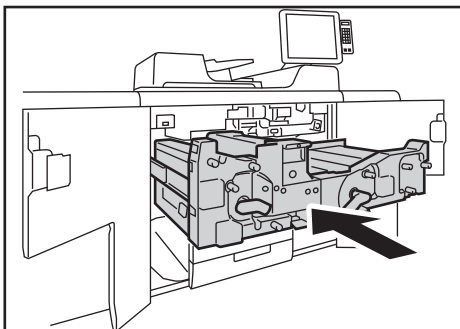

ECG023

20. Turn the machine on.

See page 17 "Turning Off/On the Power".

21. Access the Adjustment Settings for Operators menu.

See "Accessing Adjustment Settings for Operators", Adjustment Item Menu Guide: TCRU/ORU.

22. Press [Main Unit: Maintenance].

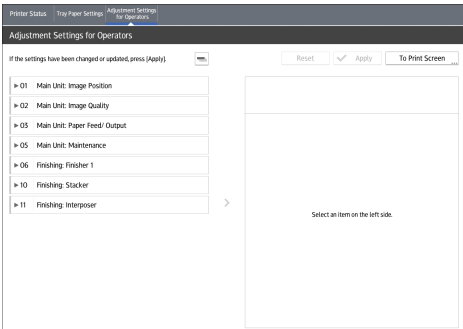

23. Press [Execute ITB Manual Lubrication].

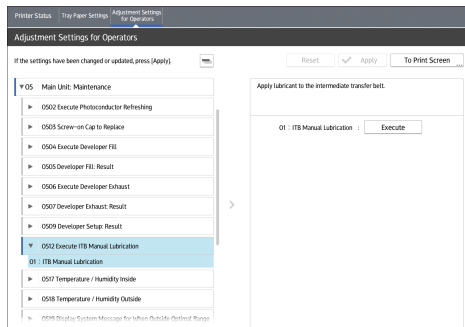

24. Press [Execute].

25. Close the front covers.

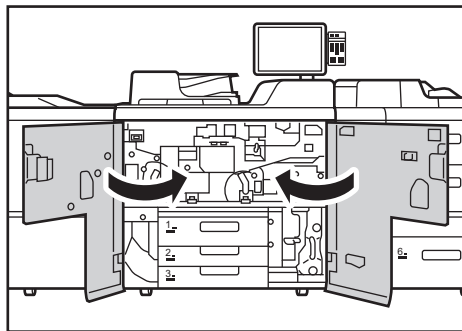

ECG007

Lubrication starts. It takes about 5 minutes.

If lubrication fails soon after starting, check the following:

- Is the cleaning unit for image transfer belt attached?
- Is the cleaning unit for photoconductor unit detached?
- Has the toner run out or almost run out?

If this operation fails halfway, contact your sales or service representative.

26. Check that lubrication has completed, and then press [Exit].

27. Open the front covers.

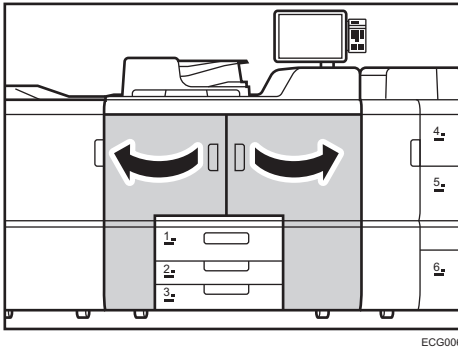

ECG006

28. Attach the paper transfer unit.

See page 112 "Replacing the Paper Transfer Unit".

29. Attach the cleaning unit for photoconductor unit.

See page 85 "Replacing the Charger Unit/Cleaning Unit for Photoconductor Unit/Photoconductor Unit".

30. Pull down the 2 levers.

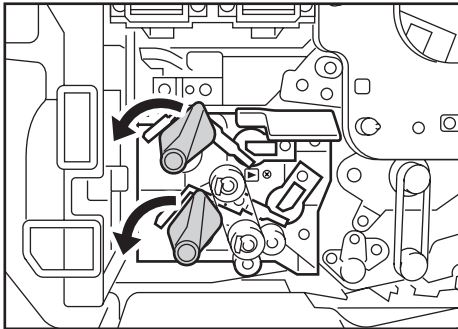

CZC090

31. Attach the cover, and then secure it with the 4 screws.

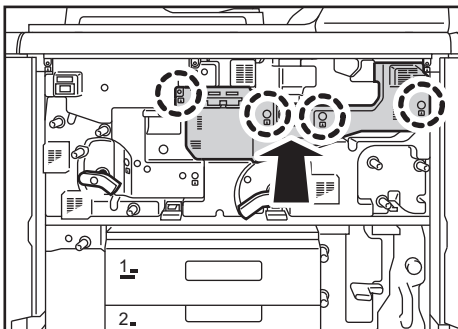

ECG066

32. Pull up the 2 levers.

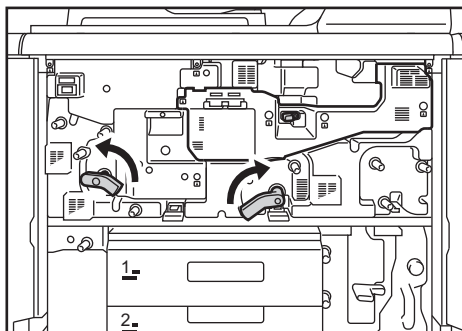

ECG065

4

33. Pull up the lever.

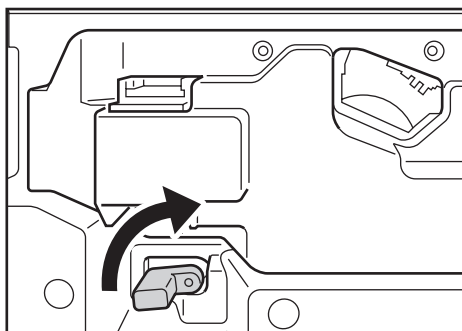

CZC069

★ Important

- Push up the lever as shown in the figure. An internal spring will return the lever to its original position. If the lever is held and turned, the roller may not return to the correct position, causing an error.

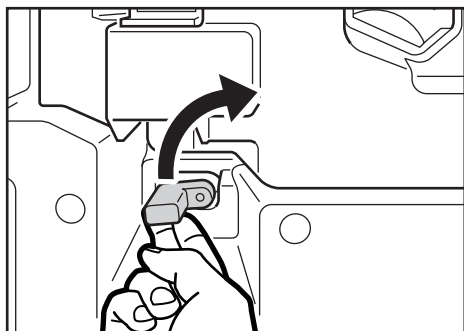

DTH003

34. Close the front covers.

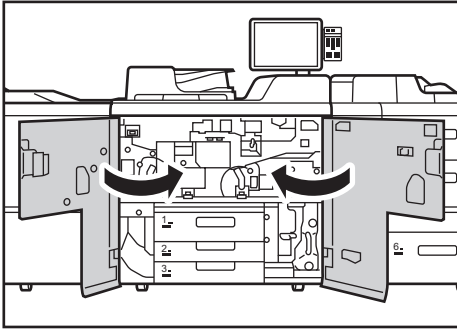

ECG007

35. Reset the counter for replaceable parts.

Do not turn the machine on until you have read how to do so.

See page 22 "Resetting the Replaceable Parts Counter".

5. Paper Transfer Unit

Before You Begin

What You Need

- Hex screwdriver
- Newspaper or other paper

Time for Replacement

A message will appear when it nears the time to replace a component.

Print the counter list.

1. Press [Counter] at the bottom of the screen in the right.
2. To print a counter list, press [Print Counter List], and then press the [Start] key.
3. Press [Exit].

5

Replaceable Parts

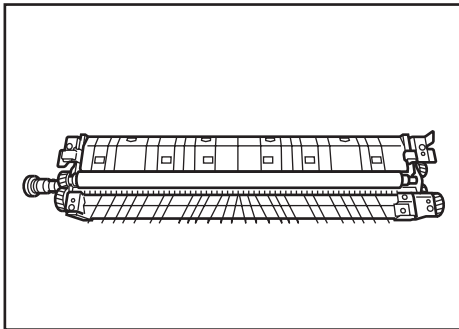

CZC093

Replacing the Paper Transfer Unit

1. Open the front covers.

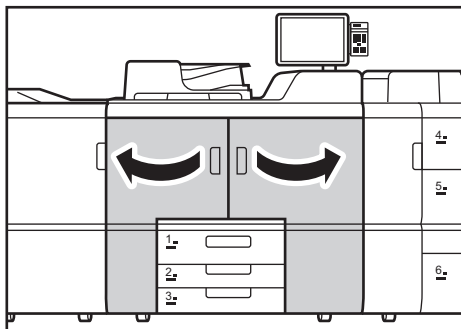

ECG006

2. Pull down the 2 levers.

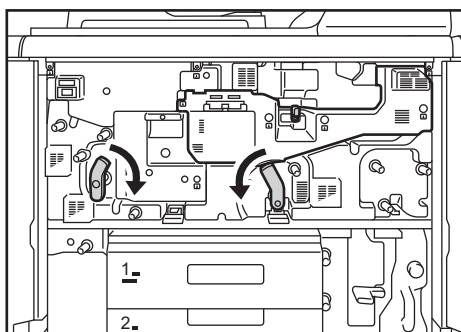

ECG062

3. Pull out the drawer until it stops.

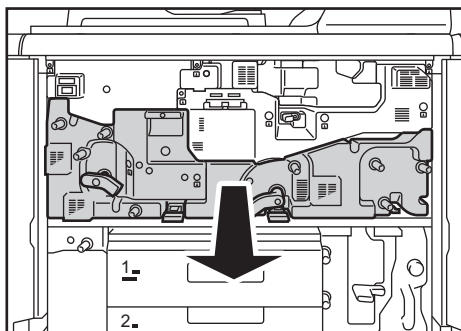

ECG067

4. Remove the 2 screws, and then slide the bracket.

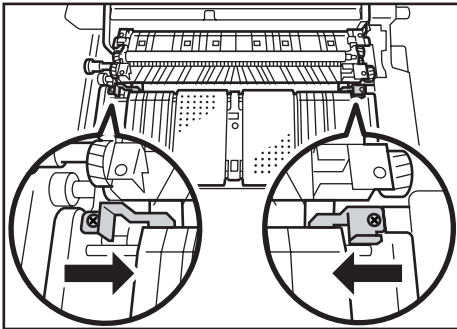

CZC095

5. Hold the label portions on each end.

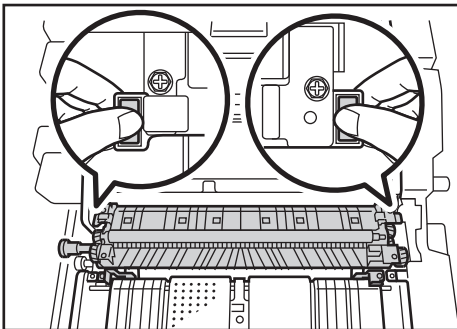

ECG052

6. Remove the paper transfer unit.

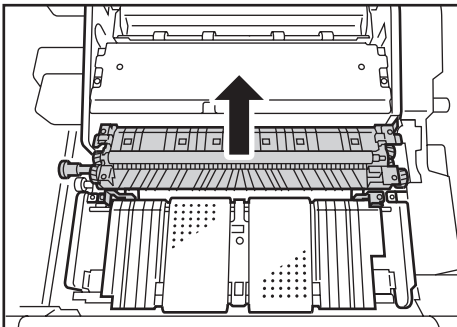

CZC096

7. Attach the new paper transfer unit by engaging the notches on its sides with the shaft.

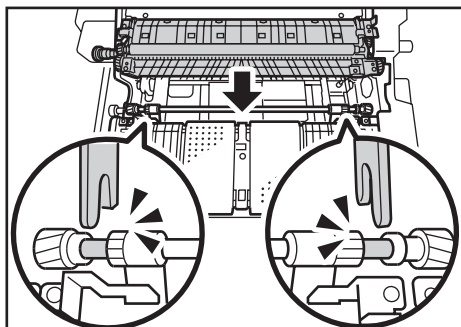

CZC099

8. Slide the bracket, and then secure the paper transfer unit with the 2 screws.

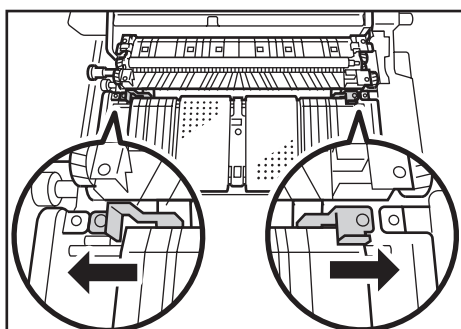

CZC098

9. Push the drawer back into the machine.

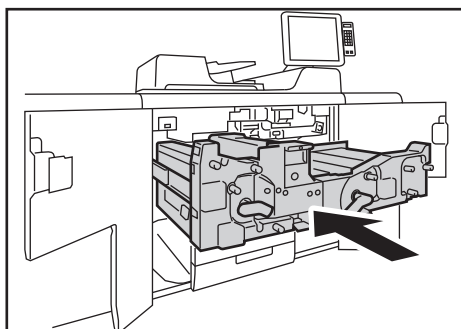

ECG023

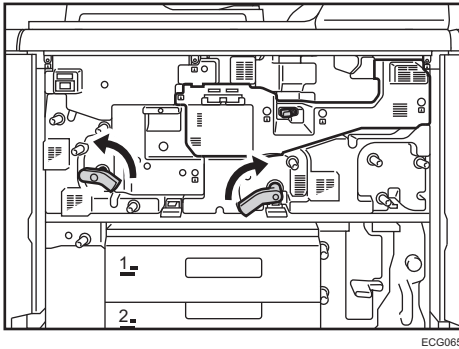
10. Pull up the 2 levers.

ECG065

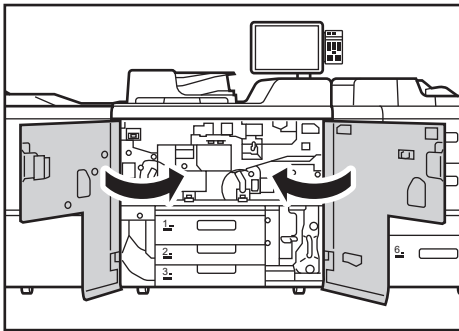
11. Close the front covers.

ECG007

12. Reset the counter for replaceable parts.

Do not turn the machine on until you have read how to do so.

See page 22 "Resetting the Replaceable Parts Counter".

6. Fusing Unit

Before You Begin

CAUTION

- The fusing unit becomes hot. When removing the fusing unit, wait for 20 minutes or more after opening the cover and confirm that the fusing unit is not hotter than the room temperature. Otherwise, you will be burned.
- The fusing unit weighs approximately around 17.0 kg (37.5 lb).
- When moving the fusing unit, lift it slowly and be careful not to strain yourself. Careless handling or over-exertion when lifting can result in breakage of the unit or injury to yourself.

What You Need

- Hex screwdriver
- Newspaper or other paper

Time for Replacement

A message will appear when it nears the time to replace a component.

Print the counter list.

1. Press [Counter] at the bottom of the screen in the right.
2. To print a counter list, press [Print Counter List], and then press the [Start] key.
3. Press [Exit].

Replaceable Parts

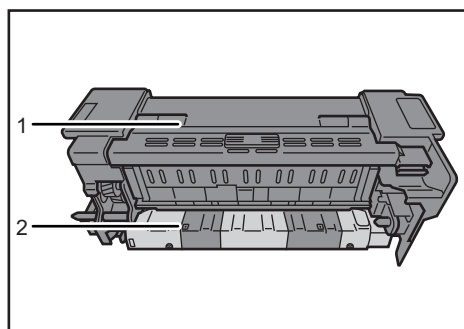

ECG053

1. Fusing assembly

2. Cleaning unit for the fusing unit

Replacing the Fusing Cleaning Unit/Fusing Unit

This section explains how to replace the cleaning unit for the fusing unit. When you replace the fusing unit, it is necessary to attach the cleaning unit for the fusing unit to the new fusing unit.

1. Open the front covers.

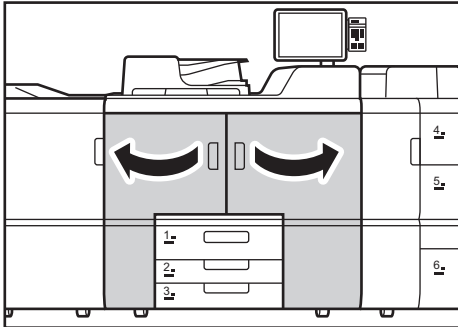

ECG006

2. Remove the 2 screws.

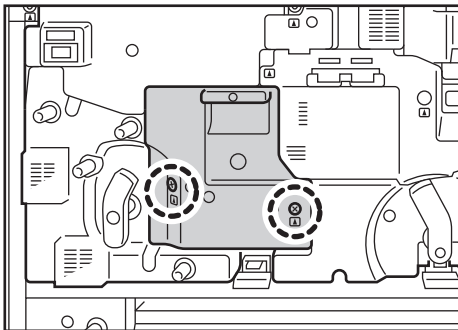

ECG068

3. Pull out the fusing unit.

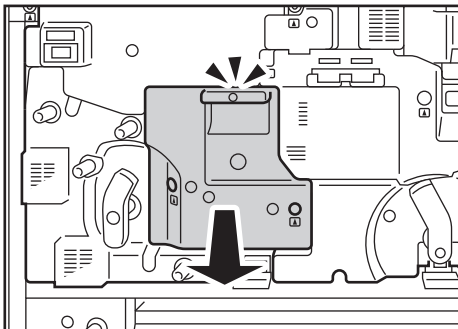

ECG069

4. Remove the fusing unit.

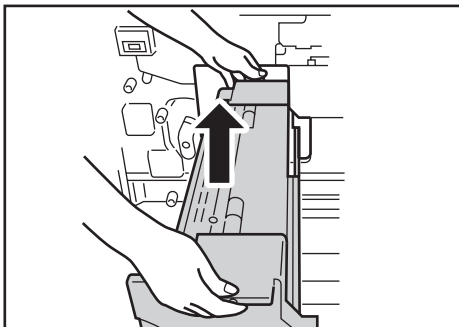

CZC103

5. Remove the screw.

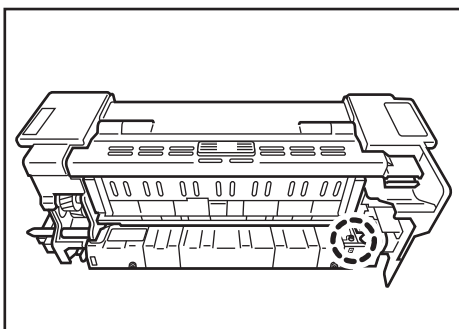

ECG025

6. Slightly lift up the right side of the fusing cleaning unit to unlock the unit, and then pull the right side of the unit out toward you.

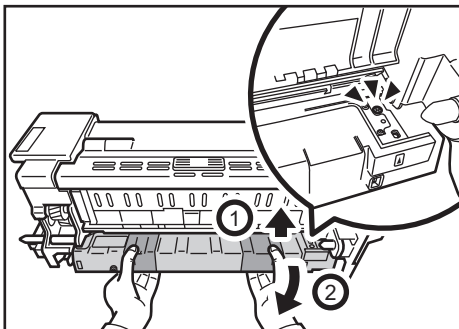

ECG024

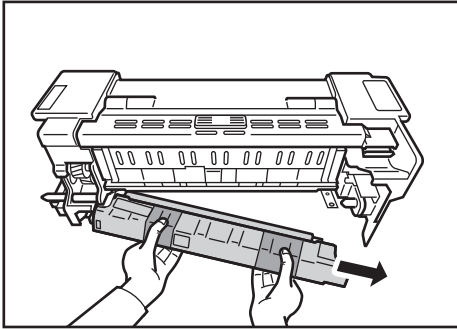
7. Remove the cleaning unit for the fusing unit.

ECG026

8. Align the projection of the new cleaning unit with the appropriate hole in the fusing unit.

When you replace the fusing unit, it is necessary to attach the cleaning unit for the fusing unit to the new fusing unit.

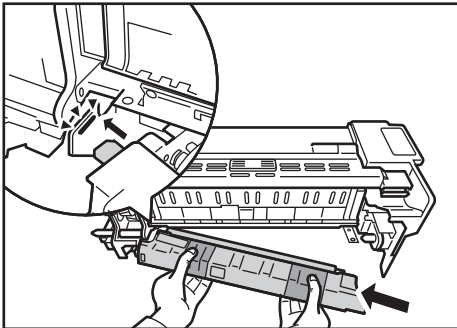

ECG027

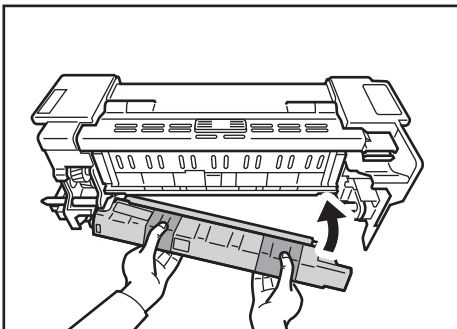
9. Push the right side of the cleaning unit inward until it locks into position.

ECG028

10. Secure the cleaning unit for the fusing unit with the screw.

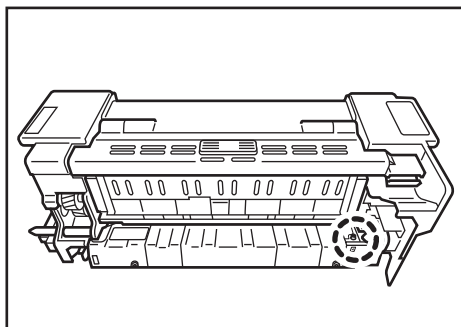

ECG025

11. Mount the fusing unit on the guide.

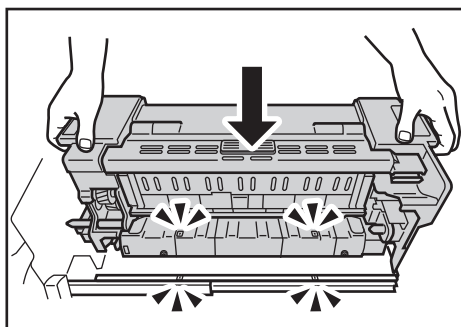

ECG029

12. Push the new fusing unit back into the machine.

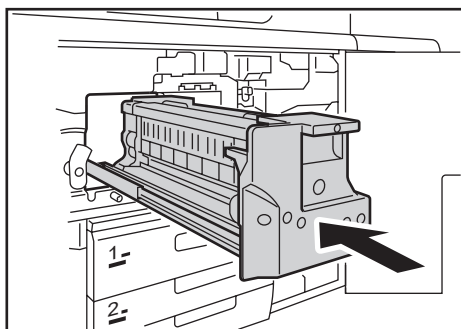

CZC107

13. Secure the fusing unit with the 2 screws.

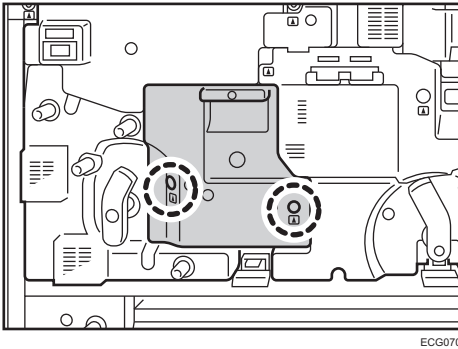

14. Close the front covers.

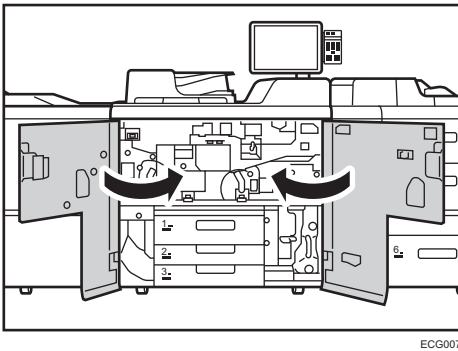

15. Reset the counter for replaceable parts.

Do not turn the machine on until you have read how to do so.

See page 22 "Resetting the Replaceable Parts Counter".

7. Developer

Before You Begin

★ Important

- Replace the developer with the machine's power turned on. A message reporting that the cover is open appears during replacement, but proceed with the replacement anyway.

What You Need

- Hex screwdriver
- Newspaper or other paper
- Developer bottle

Time for Replacement

A message will appear when it nears the time to replace a component.

Print the counter list.

1. Press [Counter] at the bottom of the screen in the right.
2. To print a counter list, press [Print Counter List], and then press the [Start] key.
3. Press [Exit].

7

Replaceable Parts

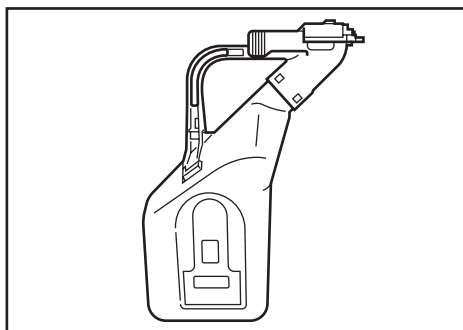

CZC111

Replacing the Developer

1. Access the Adjustment Settings for Operators menu.

See "Accessing Adjustment Settings for Operators", Adjustment Item Menu Guide: TCRU/ORU.

2. Open the front covers.

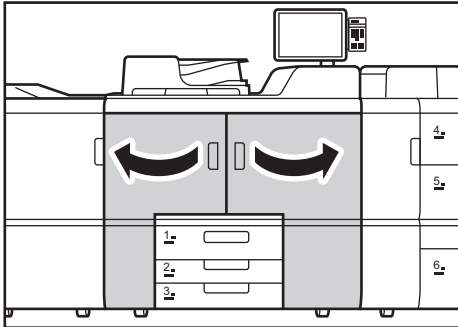

ECG006

3. Remove the 3 screws.

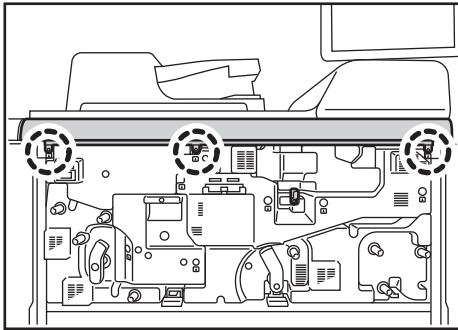

ECG019

4. Remove the cover.

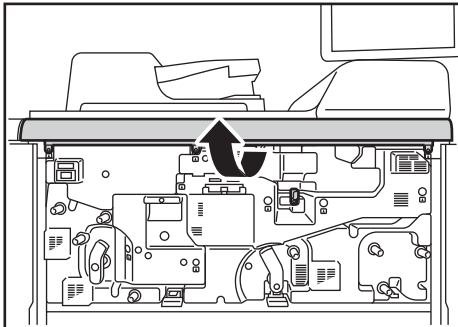

ECG020

5. Attach the developer bottle.

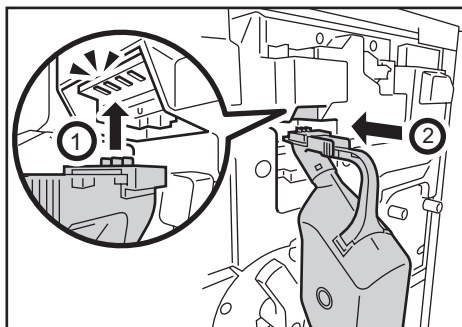

CZC112

6. Press [Main Unit: Maintenance].

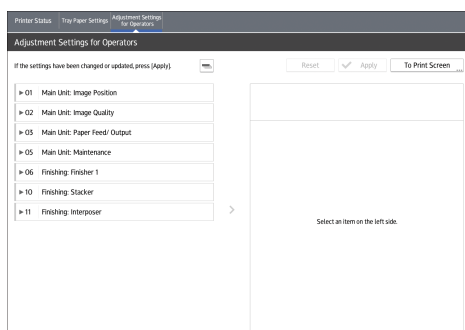

7

7. Press [Execute Developer Exhaust].

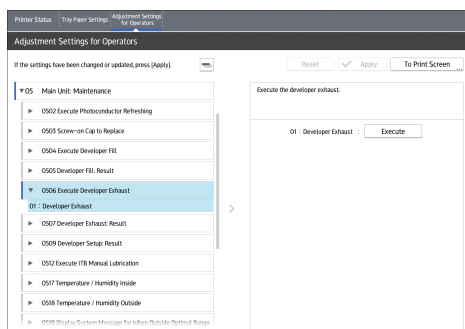

8. Press [Execute].

Discharge starts. It takes about 3 minutes.

9. Check that developer discharge has completed, and then press [Check].

10. Release the developer bottle's catch, and then remove the bottle.

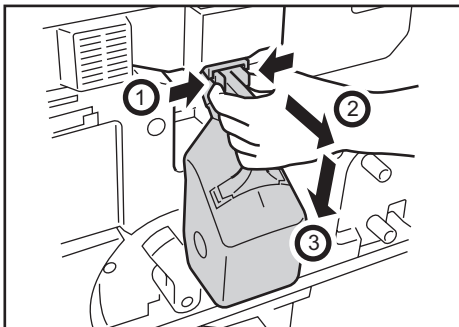

CZC118

11. Remove the seal on the side of the bottle, and then affix it to the bottle's opening.

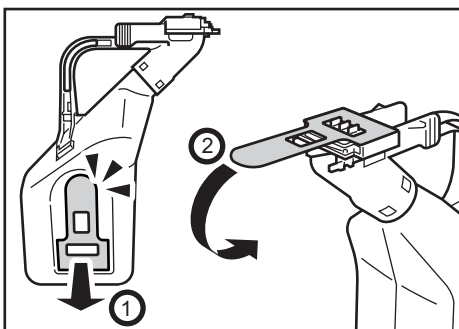

CZC113

12. Turn the new developer bottle a few times to loosen the developer.

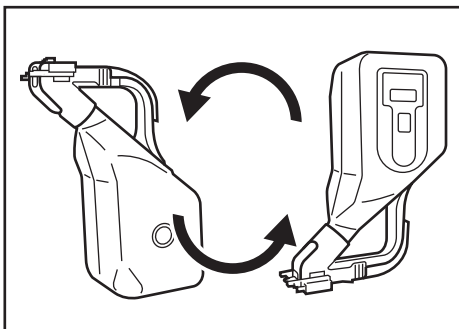

CZC114

13. Attach the new developer bottle.

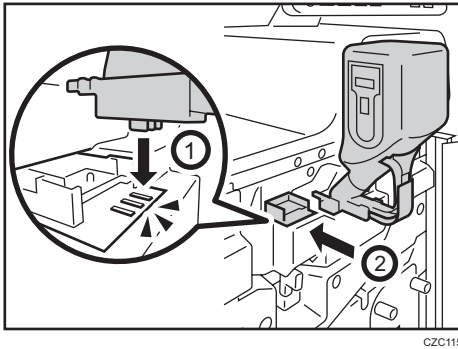

14. Pull out the seal.

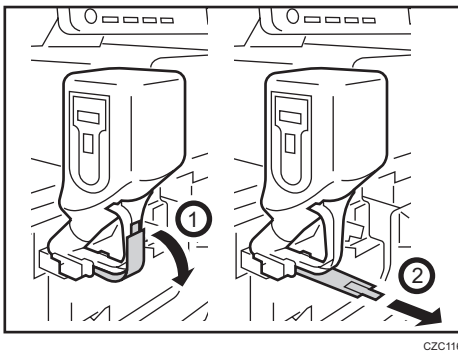

15. Press [Execute Developer Fill].

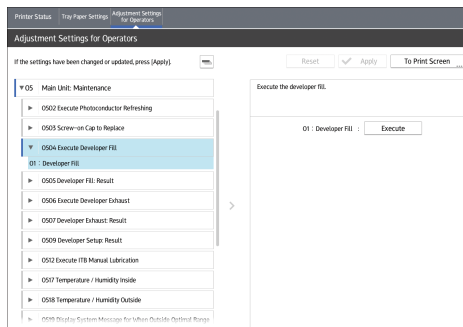

16. Press [Execute Developer Fill].

17. Press [Execute].

Replenishment starts. It takes about a minute.

18. While pouring in the developer, tap the bottle a few times so that no developer is left in the bottle.

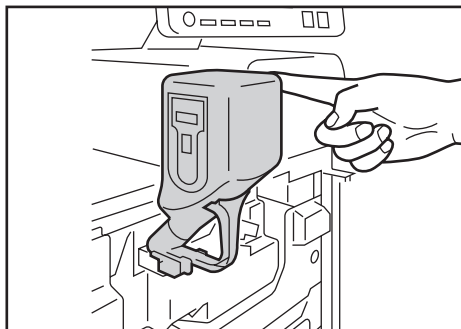

CZC117

19. Check that developer replenishment has completed, and then press [Check].
20. Release the developer bottle's catch, and then remove the bottle.

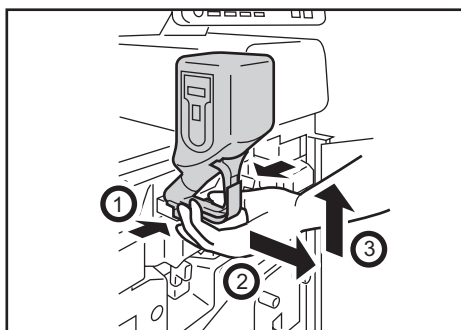

CZC119

Keep the bottle.

21. Attach the cover by aligning it with the 3 catches.

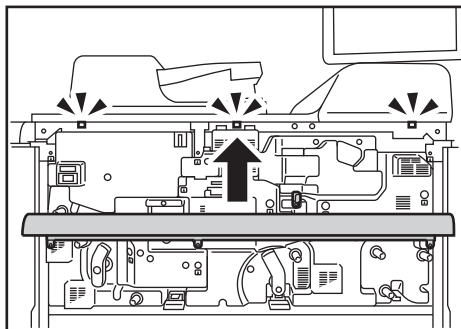

ECG022

22. Secure the cover with the 3 screws.

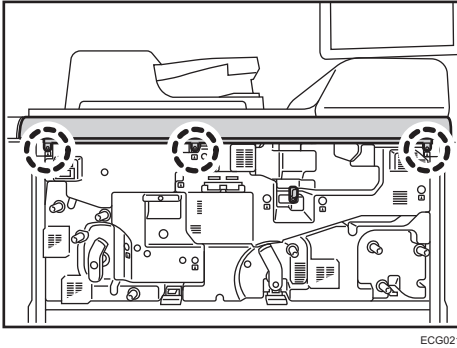

ECG021

23. Reset the counter for replaceable parts.

See page 22 "Resetting the Replaceable Parts Counter".

8. Waste Toner Bottle

Before You Begin

WARNING

- Do not incinerate toner (new or used) or toner containers. Doing so risks burns. Toner will ignite on contact with naked flame.
- Do not store toner (new or used) or toner containers anywhere near naked flames. Doing so risks fire and burns. Toner will ignite on contact with naked flame.
- Do not use a vacuum cleaner to remove spilled toner (including used toner). Absorbed toner may cause a fire or explosion due to electrical contact flickering inside the vacuum cleaner. However, it is possible to use a vacuum cleaner that is explosion-proof and dust ignition-proof. If toner is spilled on the floor, remove the spilled toner slowly using a wet cloth, so that the toner is not scattered.
- The following explains the warning messages on the plastic bag used in this product's packaging.
 - Keep the polythene materials (bags, etc.) supplied with this machine away from babies and small children at all times. Suffocation can result if polythene materials are brought into contact with the mouth or nose.

CAUTION

- Do not crush or squeeze toner containers. Doing so can cause toner spillage, possibly resulting in dirtying of skin, clothing, and floor, and accidental ingestion.
- Store toner (new or used), toner containers, and components that have been in contact with toner out of reach of children.
- If toner or used toner is inhaled, gargle with plenty of water and move into a fresh air environment. Consult a doctor if necessary.
- If toner or used toner gets into your eyes, flush immediately with large amounts of water. Consult a doctor if necessary.
- If toner or used toner is swallowed, dilute by drinking a large amount of water. Consult a doctor if necessary.

What You Need

- Newspaper or other paper

Time for Replacement

A message will appear when it nears the time to replace a component.

Print the counter list.

1. Press [Counter] at the bottom of the screen in the right.
2. To print a counter list, press [Print Counter List], and then press the [Start] key.
3. Press [Exit].

Replaceable Parts

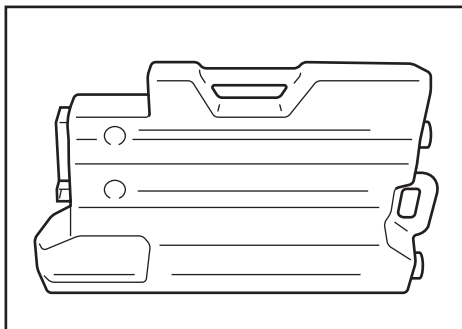

CZC120

Replacing the Waste Toner Bottle

1. Open the front covers.

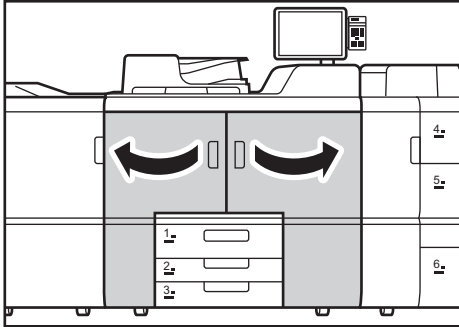

ECG006

2. Holding the handle, pull out the waste toner bottle.

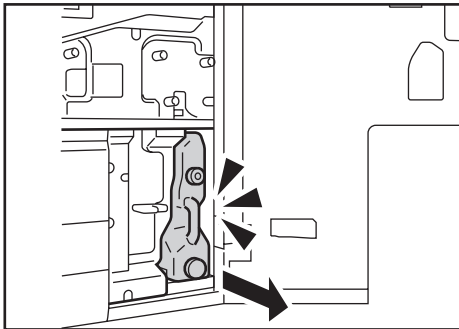

CZC121

3. Affix the seal to its opening.

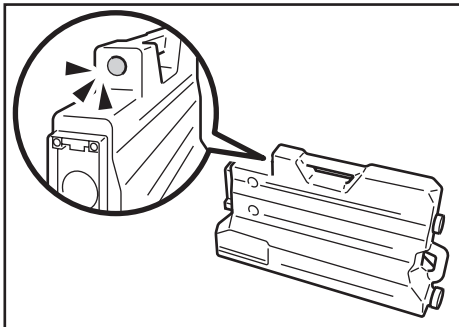

CZC122

The seal is supplied with the new waste toner bottle.

4. Put the used waste toner bottle into the bag and keep it in the box.

5. Attach the new waste toner bottle.

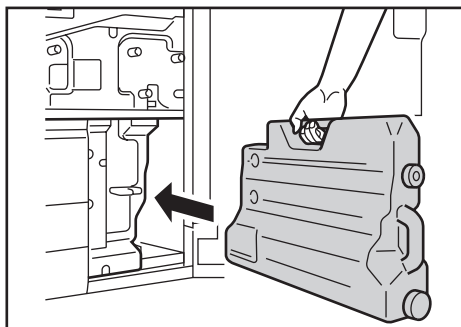

CZC123

6. Close the front covers.

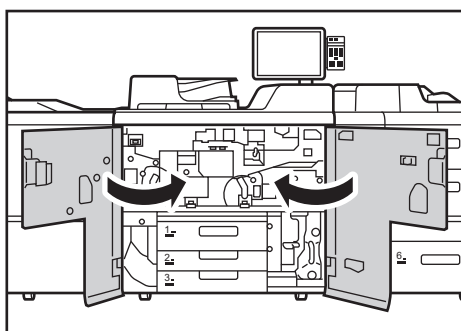

ECG007

8

7. Reset the counter for replaceable parts.

Do not turn the machine on until you have read how to do so.

See page 22 "Resetting the Replaceable Parts Counter".

